

# User Manual

Home SPA Instrument

TPS-33K3

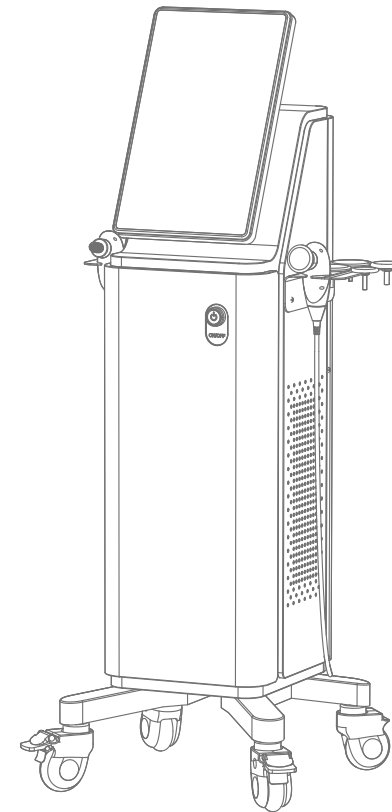

# Contents

## Part I

Safety Precautions .....	1
Contraindications .....	2
Product Overview .....	2
Packing List .....	8
Technical Specification .....	9
Key Advantages .....	9
Operation Guide .....	9
Treatment Schedule .....	15
Use Precautions .....	15
Maintenance & Cleaning .....	16
FAQ .....	16
Ask & Answer .....	17
Warranty & Support .....	19

# Safety Precautions

- 1.Please read this manual carefully before use and familiarize yourself with the operation of this instrument and related technology.
- 2.This physiotherapy instrument is a high-precision electronic device that requires proper storage. Please avoid storing it in humid conditions, direct sunlight, or near flammables and explosives to prevent damage.
- 3.Always use the designated accessory provided or recommended by the manufacturer to ensure performance throughout its service life.
- 4.Do not place the instrument in high-temperature conditions, as this may negatively impact its service life and performance.
- 5.Do not apply the instrument on the thyroid, parathyroid, testicles, pregnant women's abdomen, pacemakers, etc.
- 6.Patients should refrain from using this instrument unless they have obtained permission from their doctor.
- 7.Ensure that the instrument is applied on moist skin and avoid the operation on dry skin.
- 8.Power off the instrument when not in use to ensure its safety.
- 9.If you are currently taking anti-adiposity drugs, please discontinue their use for 1 - 2 months before using this instrument. Failure to do so may result in an extended course of treatment.
- 10.To maintain hygiene and extend the instrument's service life, sterilize it with saline.

# Contraindications

**Before using this instrument, it is essential to consult your doctor or seek advice from professionals. Details below:**

- 1.Pregnant or lactating woman.
- 2.Individuals with hypertension, heart disease, or a pacemaker installed.
- 3.Individuals with unhealed wounds or those in the recovery period from surgery.
- 4.Individuals suffering from epilepsy, severe diabetes, and hyperthyroidism.
- 5.Individuals suffering from malignant tumors, hemophilia, and hemorrhage.
- 6.Individuals with skin disease or infectious disease.
- 7.Individuals who have had a cesarean section within the last six months, a miscarriage within the last three months, or a natural birth within the last two months should refrain from using this instrument.
- 8.For your safety, refrain from using if you've had plastic surgery or have implants/metal objects near the treatment area within 3 months.

# Product Overview

## 1.Product Introduction

Recognized as a premier physiotherapy instrument, it offers a myriad of advantages, such as alleviating inflammation, providing pain relief, activating the skin, fostering wound healing, and improving circulation. This versatile tool effectively replaces various body and facial solutions typically found in salons. It stands out for its safety and efficacy, eliminating the need for injections,

medications, or surgery. The entire process is devoid of pain, invasiveness, or undesirable side effects, ensuring a gradual yet noticeable enhancement through external application. Equipped with cutting-edge 448KHz technology, a 15.6-inch touchscreen, and four interchangeable treatment heads for both RET and CET handles, this instrument facilitates comprehensive treatments for both body and face recipients, offering a visually engaging and professionally seamless operation experience for therapists.

## 2.Working principle

### CET handle

Resistive Electrical Transfer Mode: Tailored for soft tissues with higher water content, such as muscles and blood, focusing on the local and superficial areas.

### RET handle

Resistive Electrical Transfer Mode: Designed for hard tissues with lower water content, such as ligaments, tendons, joints, and bones, targeting the deep areas of the body and involving multiple joints.

### 3.Comprehensive treatment

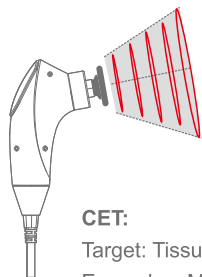

**CET:**  
Target: Tissues with high water content  
Examples: Muscle, face  
Penetration Depth: 3-4cm

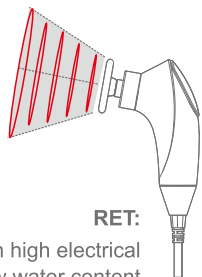

**RET:**  
Target: Tissues with high electrical resistance and low water content  
Examples: Bone, tendon, adipose tissue  
Penetration Depth: 8-10cm

### 4.Replace the treatment head

Select the desired treatment head and insert it into the terminal of the handle securely.  
Note: clean the steel tube with a brush or soft cloth before the replacement.

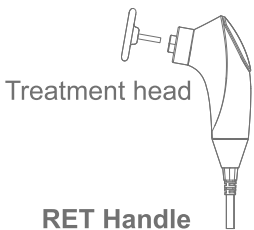
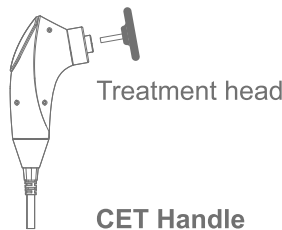

### 5.Interface Introduction

Welcome interface

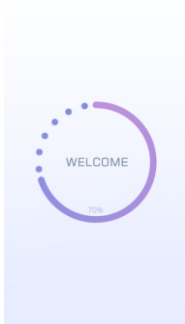

Main Menu

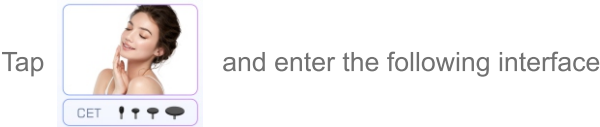

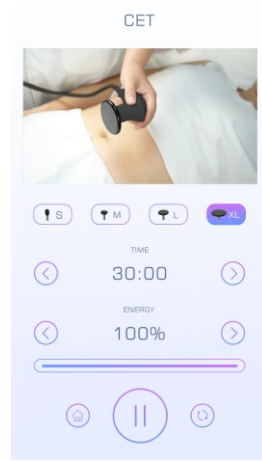

Video: There are four operation videos, each featuring a treatment head tailored for specific body areas.

S Eye M Face L Neck XL Abdomen

Time display and set buttons (0 - 60 minutes)

Energy display and set buttons (0 - 100% levels)

Dynamic Energy Indicator: The illuminated border of the energy bar signifies the operational status, providing a visual cue that the machine is actively engaged.

Main Menu On/off button Reset button

Tap RET and enter the following interface

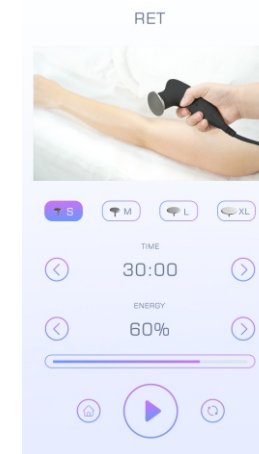

Video: There are four operation videos, each featuring a treatment head tailored for specific body areas.

S Arm M Leg L Abdomen XL Back

Time display and set buttons (0 - 60 minutes)

Energy display and set buttons (0 - 100% levels)

Dynamic Energy Indicator: The illuminated border of the energy bar signifies the operational status, providing a visual cue that the machine is actively engaged.

Main Menu On/off button Reset button

## Packing List

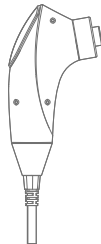

RET handle x 1

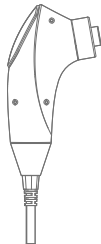

CET handle x 1



Treatment head of  
RET handle x 4



Treatment head of  
CET handle x 4



Negative Plate x1

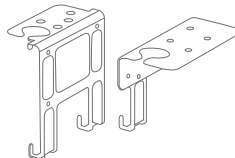

Holder x 2

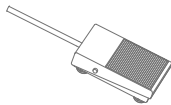

Pedal Switch x 1

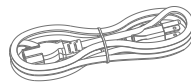

Power cord x 1

## Technical Specification

Input Voltage: AC 220~240V 50/60Hz

Rated power: 300W

RF frequency: 448KHz

## Key Advantages

1. Achieve superior results in physical therapy by promoting circulation, fostering healing, and encouraging tissue regeneration.
2. Experience inflammation alleviation and pain relief with a safe and effective procedure that avoids discomfort or invasions.
3. Access instructional videos showcasing unique massage techniques for a more informed and effective treatment.
4. Featuring a 15.6-inch touchscreen and a robust metal vertical case, ensuring durability and stability for long-term service.
5. Benefit from a unique assembly method for the treatment head, providing a convenient and swift usage experience.

## Operation Guide

### Facial, Eye, and Neck treatment

1. Prepare the instrument, assemble the components, and connect the power.
2. CET handle application: Attach the negative plate to the client's abdomen or back.
3. Turn on the power switch on the back of the main unit.

4. Turn on the main switch on the front of the main unit.
5. Set the energy level, starting at 30%, and adjust as per the recipient's tolerance.
6. Recommended working time: 10 - 20 minutes
7. Tap the on/off button to start, place the handle on the treatment area, and then depress the pedal switch.

### Face

Parameters setting

Recommended working time: 20 minutes.

Recommended energy: 30%

Recommended treatment area setting: FACE

Product required: massage cream

Recommended handle: CET(M)

Recommended handle: CET(M)

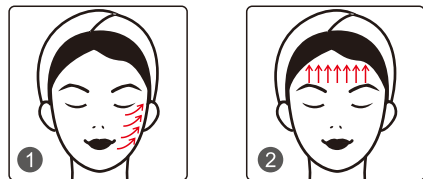

### Eye

Parameters setting

Recommended working time: 20 minutes.

Recommended energy: 30%

Recommended treatment area setting: FACE

Product required: massage cream

Recommended handle: CET(S)



### Neck

Parameters setting

Recommended working time: 20 minutes.

Recommended energy: 30%

Recommended treatment area setting: FACE

Product required: massage cream

Recommended handle: CET(L)

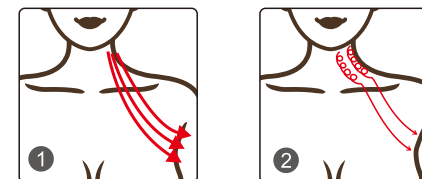

## Body treatment

- 1.Prepare the instrument, assemble the components, and connect the power.
- 2.RET handle application: Attach the negative plate to the client's abdomen or back.
- 3.Turn on the power switch on the back of the main unit.
- 4.Turn on the main switch on the front of the main unit.
- 5.Set the energy level, starting at 30%, and adjust as per the recipient's tolerance.
- 6.Recommended working time: 20 - 30 minutes
- 7.Tap the on/off button to start, place the handle on the treatment area, and then depress the pedal switch.

## Arm

Parameters setting

Recommended working time: 30 minutes

Recommended energy: 30%

Recommended treatment area setting: BODY

Product required: massage cream

Recommended handle: RET(S)

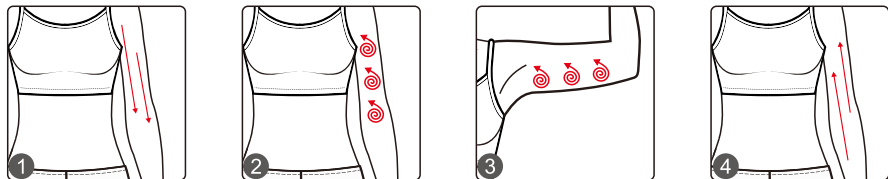

## Belly

Parameters setting

Recommended working time: 30 minutes

Recommended energy: 30%

Recommended treatment area setting: BODY

Product required: massage cream

Recommended handle: CET (XL)+RET(L)

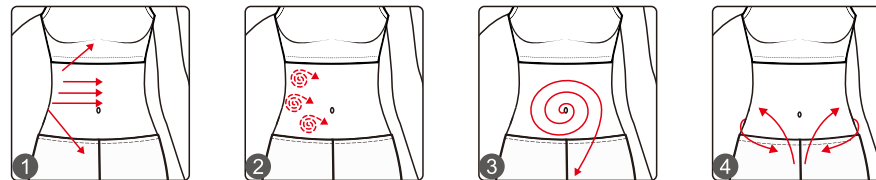

## Back

Parameters setting

Recommended working time: 30 minutes

Recommended energy: 30%

Recommended treatment area setting: BODY

Product required: massage cream

Recommended handle: RET(XL)



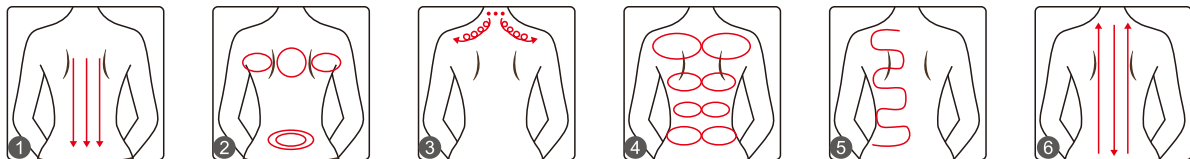

## Leg

Parameters setting

Recommended working time: 30 minutes

Recommended energy: 30%

Recommended treatment area setting: BODY

Product required: massage cream

Recommended handle: RET(M)

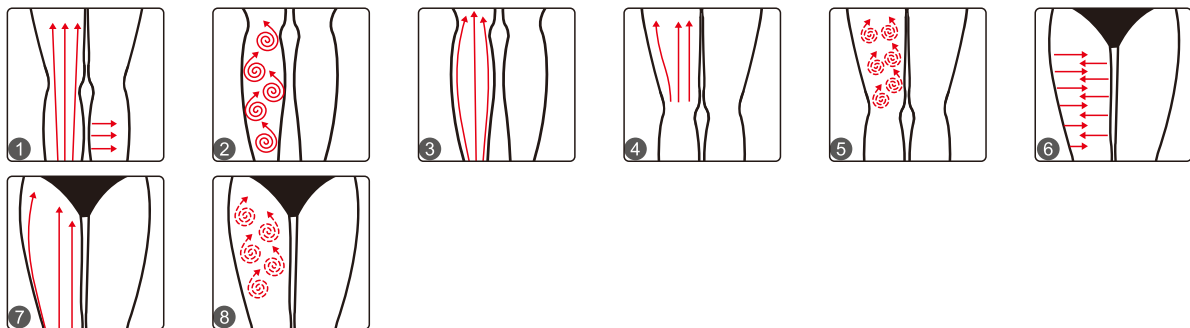

## Technical Specification

Treatment area	Treatment duration	Treatment interval	Total sessions
Face	10-20mins	7 days	10 sessions
Eye	10-20mins	7 days	10 sessions
Neck	10-20mins	7 days	10 sessions
Abdomen	20-30mins	2 sessions per week	12 sessions
Arm	20-30mins	2 sessions per week	12 sessions
Back	20-30mins	2 sessions per week	12 sessions
Leg	20-30mins	2 sessions per week	12 sessions

## Use Precautions

1. Strictly follow the instructions in the manual to use the instrument and train operator.
2. Before using the instrument, use a plug with a grounding pin and ensure the power socket is grounded.
3. Make sure the voltage of the instrument is adapted. If the local power supply voltage is unstable, we recommend adding a power-matched regulated power supply between the mains and the instrument.
4. Remove all the metal objects inside the body to avoid causing accidents or affecting treatment effects.
5. Stop the intake of anti-adiposity drugs 1 - 2 months before the treatment, or extend the treatment course if you want to take the treatment immediately.

- 6. Refrain from using the instrument on an empty stomach, and initiate the treatment one hour after a meal.
- 7. Ensure full skin contact with the treatment head throughout the session to avoid uneven heat distribution.

## Maintenance & Cleaning

- 1.Disconnect the power cord when not in use and store the instrument in a dry, cool, and well-ventilated place.
- 2.Clean and sanitize the applicator with a damp cloth or saline, and then dry it thoroughly with a dry towel to ensure it remains dry.
- 3.After cleaning the instrument, cover it with a dustcloth or plastic wrap. Before use, ensure to sanitize the handle again for hygienic reasons.
- 4.Disassembling the instrument and attempting to clean the inside is strictly prohibited. This task should only be performed by professionals.

## FAQ

### 1.When can I expect to observe the results?

A: Normally, noticeable results can be observed on the day of the treatment and within a week afterward. Grounded in endogenesis heat therapy, this device employs capacitance and resistance to transmit energy, operating on the internal tissues of the human body. It triggers the natural reparative process, delivering an anti-inflammatory effect. The visibility of results tends to increase with the number of sessions you undergo.

### 2.Is it safe for the skin?

A: Yes, it is a non-surgical method that stimulates collagen regeneration and metabolism in the deeper layers of the skin without causing any harm. Temporary heat and redness in the treated area are normal, indicating increased circulation, and should subside within a few hours. There is no need to be concerned about this reaction.

### 3.Any side effects?

A: No, there are no side effects. This instrument aims to promote tissue regeneration and circulation while delivering benefits like inflammation alleviation and pain relief.

## Ask & Answer

Ask		Cause		Answer
1.Fail to turn on the instrument.	→	The power cord is disconnected from the wall socket.	→	Check if the power cord is well connected to the wall socket and ensure that the socket is functional.
	→	The fuse is loose or burned.	→	Replace the fuse on the back of the instrument and restart it.
2. The instrument is not working and can't be restarted.	→	The fuse may have burned out due to unstable voltage or prolonged use.	→	Please replace the fuse and restart the instrument 5 minutes later.

Ask		Cause		Answer
3.The screen shows an error message.	→	Data error.	→	1. Turn off the instrument, disconnect the power cord, and wait for 1 minute to restart the instrument. 2. If the above method doesn't resolve the problem, please contact your dealer.
4.The instrument is not operating.	→	The handle is not properly connected.	→	Please confirm if the handle plug is well connected to the main unit.
	→	Oil in the treatment area could result in insufficient contact between the treatment head and the body.	→	Apply some gels to the treatment area after cleaning.
	→	The treatment head is not in proper contact with the skin.	→	Ensure complete contact between the treatment head and the skin.

Warranty & Support

We provide a one-year warranty and a three-month return and replacement policy from the date of purchase.

Product Name:

TECAR Physiotherapy Instrument

Product Model:

TPS-33K3

Quality Inspection:

PASS