

OPERATING INSTRUCTION MANUAL

Hereby explain:

This instrument is for life cosmetology,
not for medical cosmetology.



BEAUTY SERIES
No.H30

First of all, I sincerely thank you for purchasing our instruments. This manual is written for better use of this instrument. Hope the company's products and services to bring you respect.

Pay attention to

The product must be used in strict accordance with the methods used in this manual. The Company shall be responsible for all the consequences caused, and the Company shall not assume any responsibility.

The Company does not make any form of security, including (but not limited to) an implied guarantee of the fact and fitness of it for a particular purpose.

The Company is not liable for errors contained in this information or for actual performance or use due to the provision of this manual.

This manual contains proprietary information protected by the patent law. Copyright, no photo, copy, copy or translation of any part of this manual without the written consent of the Company. The content contained in the manual can be changed without user notification.

The responsibility of the manufacturer

The Company is only responsible for the safety and reliability of the instrument, that is, the assembly operation, readjustment, improvement and maintenance are conducted by the personnel approved by the Company, the relevant electrical equipment complies with the national standards, and the instrument is used in accordance with the operation instructions.

This is a cosmetic instrument, can not be used in medical areas, otherwise the company will not assume any responsibility.

If the beauty agency responsible for using this instrument cannot achieve a satisfactory operation plan, abnormal instrument failure will occur. Today, the company will provide a paid circuit diagram upon request, and will provide a list of calibration methods and other information to help the user by the appropriate, qualified technicians to repair the instrument parts that can be repaired by the user.

Pledge

Manufacturing process and raw materials: The Company guarantees that the instruments (except accessories) will have no production process and raw material failure within one year from the date of shipment. Any inspection of the Company is not complete.

In this manual

This user manual contains all the general information for this instrument. This is the starting point for new users to use the instrument, because it gives a general introduction to the system, explains how it works, and introduces the installation of the instrument and various operation methods. The required information can be found through the catalog.

This manual is read for people familiar with the cosmetic knowledge related to this instrument and experienced in using cosmetic manipulation equipment.

1. Notes

1.1 Notes for the use place

warn:

- 1) Please do not use and connect to the socket to avoid the fire occurrence;
- 2) Turn off the power switch during maintenance, so as not to cause fire and personnel electric shock;
- 3) The 100-220V \pm 10%, 50HZ-60Hz \pm 1 HZ power supply and effective grounding socket must be used;
- 4) The damaged or processed power cord is in danger of fire or electric shock;
- 5) Do not bend or twist the power cord to avoid fire or electric shock;
- 6) If the instrument is loose or damaged, please contact the company in time;
- 7) Do not use this instrument in unstable environments such as tilt, vibration and impact;
- 8) No water or debris enters inside the instrument. In case of foreign matter, please contact the company in time;
- 9) The power plug must be unplugged when the instrument moves;
- 10) When the instrument moves, it should avoid vibration as far as possible;
- 11) The instrument should be placed in a stable place, and at least 5cm of space should be left around, to ensure the air circulation, conducive to the heat dissipation of the instrument;
- 12) The instrument should not be covered with anything to prevent ventilation blockage;
- 13) Avoid the use of this instrument in the following environments: sunlight exposure; high humidity environment; near water environment; vibration, and tilt; strong magnetic field environment; electromagnetic wave and impact voltage occurrence; chemical storage, corrosive gas places;
- 14) This instrument shall not be placed near the radio, TV, photocopier, fax machine, etc.;
- 15) Do not use them with other instruments (such as microwave) to avoid mutual interference with the instruments and cause misoperation.

1.2 Notes before use

- 1) Must read the operation instructions carefully before starting up. The operator must be familiar with the operation manual and operation methods, and the instrument must be managed by special personnel;
 - 2) The operation parameters should be set under the guidance of professionals;
- pay attention to:
- 3) Verify whether the instrument is in a normal operation state before use;
 - 4) Ensure whether the grounding wire is correctly connected;
 - 5) To confirm that all the wires are correctly connected and safe;
 - 6) When using instruments, must use correctly, otherwise there may be danger, must be paid great attention.

1.3 Notes in Use

pay attention to:

- 1) When the instrument or the customer is abnormal during the operation, the operator shall immediately remove the operation handle from the customer and press the stop switch to stop the use of the instrument;

pay attention to:

- 2) During the operation of the instrument, to constantly observe the situation of beauty guests and instruments, and pay attention to whether there is any abnormal situation at any time;
- 3) The instrument shall be used correctly by the skilled operation technician, and the personnel other than the operation technician shall not use the instrument.

1.4 Notes after use

pay attention to:

- 1) After the operation, the control handle is put back to the control handle hanger.
- 2) After using the operating handle, clean the probe and recycle the instrument (pack the solution bottle with water and clean it around) for the next use.

1.5 Notes during fault, storage and inspection

warn:

- 1) Do not use the instrument if it is abnormal. In case of smoke coke smell, can not operate, if continue to use, there is a danger of fire electric shock. Please press the stop button, turn off the power, unplug, and contact the company or dealer immediately;
- 2) Personnel other than technical personnel shall absolutely not repair or modify the equipment. This instrument is not be inside!

pay attention to:

- 3) Instruments and components must be checked regularly;
- 4) Do not use cleaning tools that damage the instrument protective coating, such as brush, brush, etc.;
- 5) If the instrument is not used for more than 2 weeks, the instrument must be carefully checked before using it again.

1.6 Warning and prompt instructions

pay attention to:

When using the instrument near short wave or microwave equipment (1m), the instrument output may be unstable due to microwave interference.

2. Introduction to the instrument

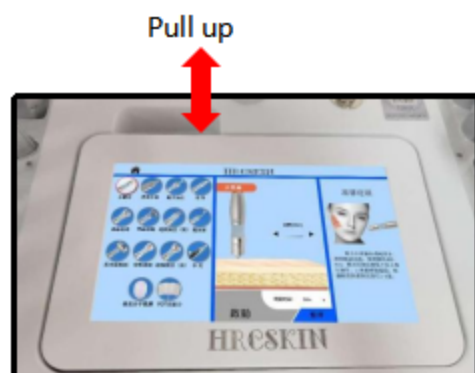

(HD smart touch screen)

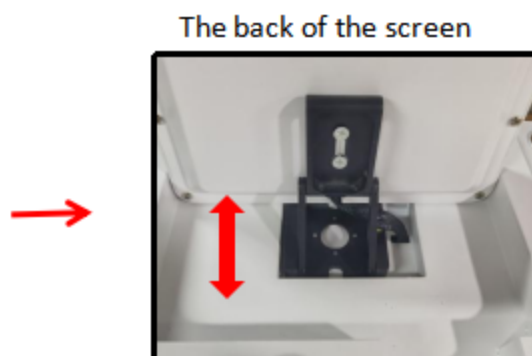

(screen adjustable up and down, 180 degrees)

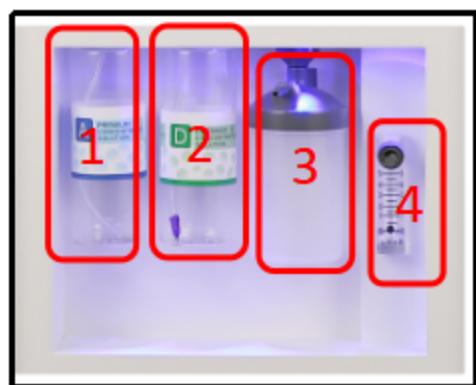

1. Solution bottle A of the suction pen;
2. Magic bubble pen of bubble water D bottle;
3. Oxygen wet flower pot of base molecular oxygen therapy;
4. Oxygen flowmeter adjustment of base molecular oxygen therapy;



1. Adjust the suction size of the suction pen, both clockwise and small counterclockwise;
2. Adjust the water flow size of the suction pen, reduce it clockwise and counterclockwise;
3. Adjust the size of the oxygen pen, reduce it clockwise and counterclockwise;



the back



1-3 Photodynamic adjustment knob (release the knob first, Adjust to the proper position, and then tighten the knob.)

1. Water oxygen pen water bottle;
2. Waste water bottle (when absorbing sewage is full, need to pour Drop and clean, install and tighten the bottle)
3. Filter (instrument must be installed otherwise
When the suction pen has no suction, and the filter has water,
Get rid of it in time! Clean it up and then plug it in.)
4. Power switch / power cord interface;



Left handle, handle interface (name installation) Right handle, handle interface (name installation)

1. Instrument water injection outlet /
overflow outlet / drainage outlet

3. Profile of handle

Left-side — handle



Water light



Cleaning
hand tools



Overclocking
lifting (face)



Electric roller * 2



Suction pen

Right-side — handle



Ion acne
elimination



Overclocking
lifting (eye)



Wave
superconductor



Soft light
activation brush



Magic bubble
pen



Cold and
heat cycle



Oxygen
pen

4. Installation instructions

4.1 Unpack the box and check it

4.1.1 Carefully remove the instruments and accessories from the packing box, and keep the packaging materials for later transportation or preservation. Count the attachment.

4.1.2 Check for any mechanical damage.

pay attention to:

Contact our sales department or agent immediately if you have any questions.

4.2 The instrument shall be placed in a room with a temperature of $5^{\circ}\text{C} \sim 40^{\circ}\text{C}$, a humidity not exceeding 80%, clean and ventilated, to avoid direct sunlight. And ensure that the vents are not blocked, ensuring that there is at least 5cm space around the instrument. Remember not to place items on the instrument, even if it is temporary, it is not allowed.

4.3 When connecting the handle plug, please install it according to the hole position.

4.4 Instrument water injection method: before adding water, the "water injection mouth" and "overflow mouth outlet" screw down, the accessory bag take out 2 water pipe with screw cap, will have the funnel water pipe installed in the "water injection mouth", no funnel of the water pipe installed in the "overflow water outlet". Fill the water from the funnel of the "water injection outlet" into the pipe until the "overflow outlet" flows evenly, indicating that the water is filled. After filling up the water, then screw down the pipe with the cap for storage so as not to lose, tighten the "water injection mouth" and "overflow mouth mouth" cap.



(Note: can only add pure water or distilled water, change once in 30 days!)

Instrument water change method: first take the basin under the main engine, unscrew the "overflow mouth mouth" and "drain mouth" first put the water clean, and then according to the above "water injection method" to fill up the water can be.

5. Operating procedures

5.1 Before nursing, please remove all the metal accessories. Clean the face (remove your makeup and clean it).

5.2 Wear inspection gloves to disinfect the main engine and base, and dip small cotton swabs in alcohol to disinfect the 12 probes (disinfect all before and after using the handle).

5.3 Start up in, open the machine interface  , click to select traditional  Chinese or English.

5.4 Select the operating probe, click "Magic bubble pen" mode; remove makeup and clean the facial skin.

Enter the operation interface, D bottle of bubble water;

Select "Time" and click "◀ ▶" to adjust the appropriate time;

Click Start / Pause;



First prepare a beauty basin, D bottle installed bubble water, the magic bubble pen probe to the beauty basin, choose the start function, bubble coherent outflow, in the face from the chin to the forehead direction circle, from the big circle slowly cover to the whole face to stay for 1-3 minutes (avoid the nostrils can be used to stick the cotton patch in the mouth and nose to avoid bubble into).

5.5 Select and click on the "Suction pen" mode; clean the facial skin.

Entering the operation interface, it is recommended to install nutrient water or special small bubble water in bottle A;



Rotate the "1" knob to adjust the appropriate suction size; (rotate larger clockwise and smaller counterclockwise according to the icon)

Rotate the "2" knob to adjust the appropriate water flow size; (rotate smaller clockwise and larger counterclockwise according to the icon)

Select "Heating" and click "◀ ▶" to adjust the appropriate temperature;

Select "Time" and click "◀ ▶" to adjust the appropriate time;

After adjusting the water flow size / suction size, click start / pause;



Choose suitable for customer skin head (normal skin with hard head, sensitive skin with soft glue head) choose the corresponding solution bottle open the switch, press the head with the thumb, adjust the appropriate suction and water flow, along the face up to the top, can be fixed point operation or short distance pull (1-2cm) operation, face 1-2 times, T area can strengthen the operation.

Note: When the wastewater bottle is full, the suction pen will automatically stop working. Remove the wastewater bottle and install it, and you can start the work again.

5.6 Select the "Cleaning hand tools" mode, enter the operation interface, clean the facial skin, and apply uniform facial toner or pure water.

Select mode: 1 is continuous mode, 2 is short intermittent mode, 3 is long intermittent mode;

Select "Strength" and click "◀ ▶" to adjust the appropriate energy;

Select "Time" and click "◀ ▶" to adjust the appropriate time;

Click Start / Pause;



Energy starts from 1, adjusted according to the customer needs, partially cleaned 1-2 times, T area can be strengthened operation.

5.7 Click "Oxygen pen" mode to enter the operation interface. It is recommended to install saline or pure water or other water agent products in the following bottle. (It must be water agent, if there is thick, please use saline or pure water into water agent to avoid blocking).

Select "Time" and click " ◀ ▶ " to adjust the appropriate time;

Click Start / Pause;

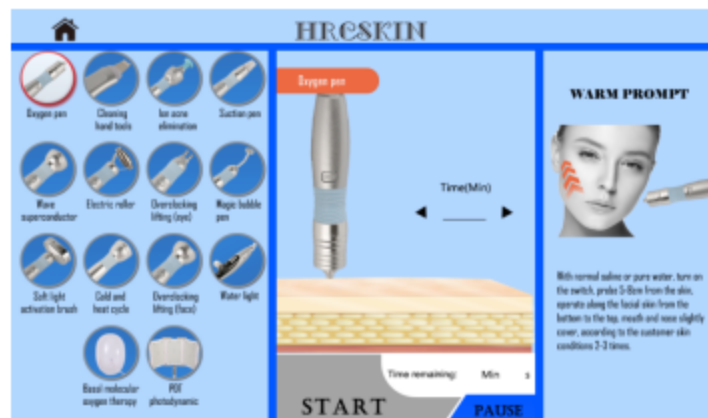

Adjust the appropriate water flow, operate along the facial skin from the bottom up, and cover the mouth and nose slightly, according to the customer's skin conditions for 2-3 times.

5.8 Select "Ion acne elimination" mode, enter the operation interface, clean the skin, keep the skin clean and dry after cleaning. (Before operation, please wear disposable beauty gloves.)

Select large probe (operating face) or small probe (operating small area of nose and mouth)

Select "Energy" and click " ◀ ▶ " to adjust the appropriate energy;

Select "Time" and click " ◀ ▶ " to adjust the appropriate time;

Click Start / Pause;

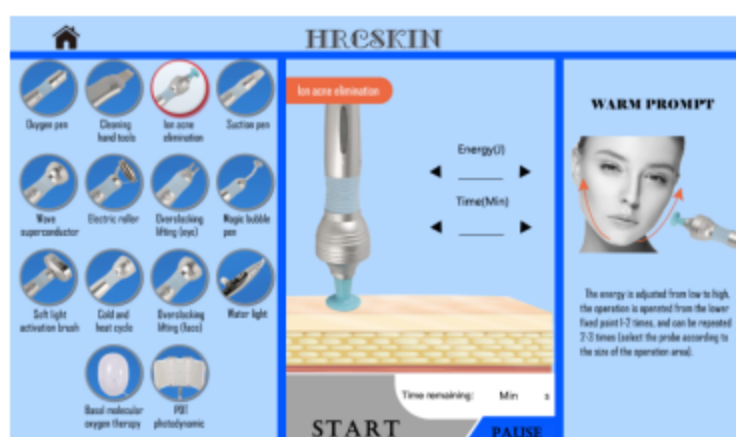

Energy from low to high adjustment, the operation from the next fixed point operation 1-2 times, for acne parts can be repeated 2-3 times.

5.9 Select the "Wave superconductor" mode, enter the operation interface, clean the facial skin, and apply the uniform nutrient solution / nutrient cream to the face.

Select mode: 1 is continuous mode, 2 short intermittent mode, 3 for long intermittent mode;

Select "Energy" and click "◀ ▶" to adjust the appropriate energy;

Select "Time" and click "◀ ▶" to adjust the appropriate time;

Click Start / Pause;



The energy starts from 3, is adjusted according to the customer's endurance, and is circled along the bottom to the five lines of the face.

5.10 Click "Electric roller" mode to clean facial skin and apply uniform nutrition solution / nutrition cream.

Select mode: 1 is continuous mode, 2 short intermittent mode, 3 for long intermittent mode;

Select "Energy" and click "◀ ▶" to adjust the appropriate energy (from low to high);

note that both handles must be held flat to the skin to feel, one handle alone is not felt! At working, do not two probes together!

Select "Time" and click "◀ ▶" to adjust the appropriate time;

Click Start / Pause;



According to the face direction from the bottom to the upward promotion operation, the V-shaped area can be used for the law lines, apple muscle, C can go down from the two sides of the nose to the upper direction of the ear, the operation for 10-15 minutes.

5.11 Click the "Overclocking lifting (eye)" mode, enter the operation interface, clean the eye skin, and apply uniform nutrient solution / nutrient cream to the eye.

Select "Energy" and click " ◀ ▶ " to adjust the appropriate energy; **note that the handle poles must be completely flat skin, a single pole contact skin will cause customer discomfort!**

Select "Time" and click " ◀ ▶ " to adjust the appropriate time;

Click Start / Pause;



Make the probe and the skin complete contact, energy from 1, according to the customer's bearing ability to adjust, respectively from the present side and above the eye, along the inner corner of the eye to the temple sliding pull (pay attention to avoid the eyeball). All faces are available.

5.12 Click on the "Overclocking lifting (face)" mode to clean the facial skin, and apply the uniform nutrient solution / nutrition cream on the face.

Select "Energy" and click " ◀ ▶ " to adjust the appropriate energy; **note that the handle poles must be completely flat skin, a single pole contact skin will cause customer discomfort!**

Select "Time" and click " ◀ ▶ " to adjust the appropriate time;

Click Start / Pause;



Make the probe and the skin complete contact, energy from 1 adjustment, according to the customer's bearing ability to adjust, along the face to the five-line promotion operation.

5.13 Select and click on the "Cold and heat cycle" mode. **Note: Using this mode requires that the instrument has been injected.**

How to use: clean facial skin, face with uniform nutrition solution / nutrition cream / mask.

Select "Temperature", click " ◀ ▶ ", adjust the energy intensity (i. e., temperature) can be controlled between -10 degrees and 50 degrees, according to the actual demand adjustment.

From 36 degrees to 50 degrees, red light on, indicating heating; 10 degrees to -10 degrees, blue light on, indicating refrigeration;

Select "Time" and click " ◀ ▶ " to adjust the appropriate time;

Click Start / Pause;



Cold calm, soothing / heat promotes circulation, the energy starts from-3, adjust according to the customer needs, operate along the face from the bottom up, fixed point or sliding operation (according to the product used in the skin).

5.14 Select and click "Soft light activation brush" mode; apply uniform nutrient solution / nutrient cream;

Select "Luminance" and click "◀ ▶" to adjust the appropriate red light energy;

Select mode: 1 is continuous mode, 2 short intermittent mode, 3 for long intermittent mode;

Select "Strength" and click "◀ ▶" to adjust the appropriate energy (from low to high);

Select "Time" and click "◀ ▶" to adjust the appropriate time;

Click Start / Pause;



Energy adjustment from the lowest adjustment, the neck cycle from top to bottom operation, half side 10-15 minutes (time can be adjusted according to personal circumstances). The head can be dredged from the back direction of the printing hall, and the specific operation time can be adjusted according to the personal situation.

5.15 Select and click on the "Water light" mode.

1. Installation steps of water light handle

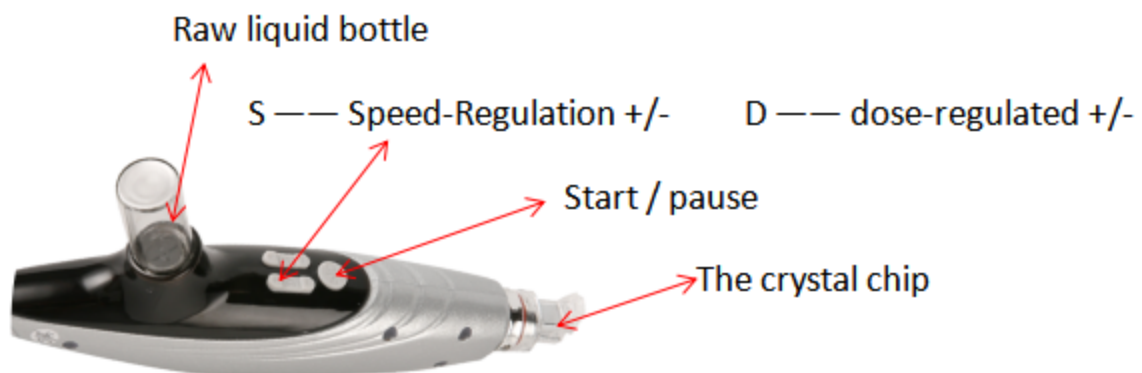

- ① microcrystal head, fix the card slot of the microcrystal head on the handle bayonet, insert clockwise rotation.
- ② poured the product into the bottle, the handle upside down and inserted into the bottle.



2. Put the normal saline into the safety bottle first, and install it to the handle. The device operates monocrystalline silicon wafer at one time, click "automatic cleaning key" to let the instrument clean the pipeline automatically. Automatic cleaning for 1-3 minutes, click to complete.

3. Put the product into the safety bottle and install it to the handle. (When the probe is operated to any position in the skin, the probe must be solid and perpendicular to the skin. Do not tilt the probe to avoid hurting the skin with some energy concentration.)

Select either the RF or the EMS;

Select mode: M1 indicates continuous mode, M2 indicates intermittent mode;

Select "Energy" and click "◀ ▶" to adjust the appropriate energy (from low to high);

Select "Time" and click "◀ ▶" to adjust the appropriate time;

Select "Speed" and "Dose", click "◀ ▶" to adjust the appropriate needle release speed and dose;

Click Start / Pause;



Make the probe and the skin complete contact, energy from the lowest adjustment, according to the customer's ability to adjust, along the facial skin from the bottom up, from the inside outside of the operation, operation for 10-15 minutes.

4. After the operation, put the normal saline into the safety bottle, device to the handle, click the "automatic cleaning key", and allow the instrument to clean the pipeline automatically.

5.16 Click on the "Base molecular oxygen therapy" mode; install 1 / 3 or 1 / 2 of pure water or distilled water in the oxygen wet flower pot; mainly with non-woven mask, the skin can fully breathe and absorb oxygen, and fully absorb the effective ingredients. Can be matched with essential oil base..Remove after 10 to 15 minutes.

Select "Time" and click "◀ ▶" to adjust the appropriate time;

Click Start to adjust the appropriate oxygen flow meter; the air pressure should be adjusted to 2-3LPM during oxygen treatment.

Click to pause, that is, to stop the use;

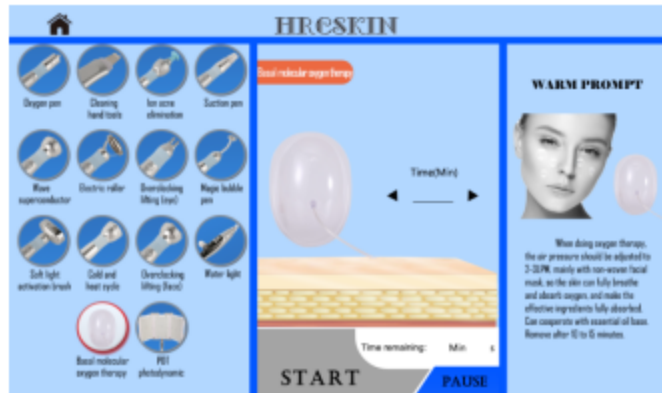

5.16 Click "PDT Photodynamic" mode; clean facial skin and apply facial mask to face. Select mode: there are three automatic modes, 1. Red light + blue light, three seconds each; 2. Red light + green light, three seconds each; 3. Red light + mixed light, three seconds each; Or choose the kind of light, —, "red light" / "blue light", "green light" and "mixed light"; Select "Strength" and click "◀ ▶" to adjust the appropriate light energy intensity; Select "Time" and click "◀ ▶" to adjust the appropriate time; Click Start / Pause;



=

Determine the use mode according to the customer's skin condition. Bring laser sunglasses, apply a facial mask, and choose the start function. Remove after 10 to 15 minutes.

6. Operation has ended

6.1 After the operation ends

1) Overall cleaning

Basic cleaning must be done to maintain the prevention of bacterial infections. After the use of the accessories, do not throw them at will, they should be cleaned with a cleaning liquid combined with a clean touch cloth, carefully clean, and put on the hangers. Normal saline or a little cleaner is recommended.

2) Cleaning method of the suction pen

After using the suction pen, we must use pure water to clean the channel, otherwise when the product is dry, it will affect the suction.

You can put pure water in A / B / B bottle circulation cleaning, adjust the water flow to the maximum, click "start" thumb hold the pen, long press for 10 seconds, cycle 3-5 times, so that the pure water can clean the whole pen.

Clean the suction head

The suction head must be cleaned to prevent infection. After use, use a brush stained with

detergent (which must be soft) to clean up the impurities of the suction head, and then soak it with 75% alcohol or put it in an ultraviolet sterilization disinfectant.

3) Hydopen, cleaning method

If the water oxygen pen is put in normal saline or pure water, it can be cleaned every other week.

If you put other water products, clean them after using them up every day. Put in about 1 / 5 of the pure water, adjust the water flow to the maximum, and spray it in the bottle.

4) Magic bubble pen, the cleaning method

Prepare an empty basin, a bottle of warm water, the magic bubble pen aimed at the empty basin, click "start", wait for a few seconds, out of the water, take the warm water bottle open, such as the water in the pipe all flow out, indicating that the clean click "pause";

6.2 Turn off the main power switch and remove the power cord if necessary.

7. considerations

7.1: Note that the wastewater bottle will stop working and alarm. Please pour it out in time to prevent damage to the instrument.

7.2: Customers need to remove their metal jewelry and do not play with their mobile phones.

7.3: Avoid the microsurgery of the face.

7.4: Skin allergy, inflammation, sunburn and women are prohibited.

7.5: No cardiac bypass patients.

7.6: Use with caution with thin skin cuticle or serious red blood filament of cheekbones.

7.7: Use with caution for people who have undergone facial surgery or deep exfoliation and have not yet reached the recovery period.

7.8: After operation, strengthen hydration, apply hydration mask continuously for a week, and do not use effective aquatic products.

8. Maintenance and Repair

8.1 Maintenance

8.1.1 routine inspection

Managers must inspect the instruments and components.

Whether the a) power outlet has a reliable connection to the ground, do not please replace the power socket.

b) Whether the power wire is deformed, broken, broken wire: through the naked eye inspection, whether the wire has deterioration, deformation, if any, it may be due to leakage

And it caused a fire. Change the new power cord now.

c) control handle is abnormal, broken line: through visual inspection, the output line for deterioration, deformation, if there is any, please replace immediately.

d) Please check that the prompt is correct. Please stop use.

8.1.2 is clean

When cleaning the instrument, the dust must be wiped with a dry soft cloth and the stolen goods with a soft wet cloth. Turn off the power switch and disconnect the power cord prior to cleaning

the instrument.

When 8.1.3 uses the instrument for a long time (more than one year), it shall be conducted by professional maintenance personnel.

When the 8.1.4 instrument is not used, it shall be placed in a ventilated and dry place and covered with a dust cover.

8.2 Maintenance

8.2.1 shall fill in the warranty card after purchasing the instrument and sent to the manufacturer or agent to have the warranty effect; from the date of the purchase (note: the warranty scope here is limited to the instrument host, excluding consumables to be regularly replaced).

After the 8.2.2 warranty period, please contact the manufacturer directly for the service warranty.

8.2.3 must contact the customer service department or dealer, do not repair it and dismantle it by itself. The Company will not offer warranty.

9. Common faults and troubleshooting methods

9.1 When the instrument can not work properly, do not disassemble and assemble easily, should contact our customer service department or dealer in time, find out the cause of failure.

9.2 Before requiring maintenance services, please click the following table to check the instrument to see if you can handle the problem yourself.

10. Access

10.1 The warranty for this instrument is one year. (Note: Except man-made damage)

10.2 Spare parts warranty period is 3 months. (Note: Except man-made damage)

10.3 End-of-life instruments and fittings shall be disposed of in accordance with relevant local regulations.

11. Maintenance records

Maintenance log		
Product Name: _____ Date of purchase: _____		
Maintenance date	Cause of failure	Maintenance content

(the company reserves the right of final interpretation of the said information)