

User Manual

UNOISETION Microdermabrasion Machine

SR-NF105U

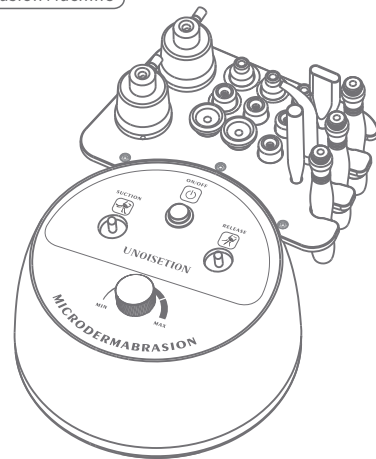

Table of contents

EN

Efficacy	1
Precautions	2
Contraindications	2
Technical Parameters	3
Packing List	4
Control Panel Instruction	6
User Guide	7
Recommended Application	15
Troubleshooting	19
FAQ	20
Warranty and Support	21

Thank you for choosing UNOISETION Microdermabrasion Machine, please read this manual carefully before use!

This machine uses a steel wand with a very fine amount of diamonds in the surface of the tip to exfoliate thick, uneven surface of skin, and removes dead skin cells by suction, makes skin glowing and smoothing. While the glass tube sucks out dirt from the pores to achieve the effect of deep cleansing the skin. In the end, get your skin hydrated and nourished with a spray bottle.

Efficacy

1. Improve age spots and blackheads.
2. Improve hyperpigmentation (darker patches on skin).
3. Exfoliate and refresh the skin.
4. Reduce the appearance of stretch marks.
5. Reduces fine lines and wrinkles.
6. Reduce or eliminate enlarged pores.
7. Treat acne and the scars associated with acne.
8. Reduce blackheads, whiteheads and acne.

Precautions

1. Please read this manual carefully before use so you are familiar with the use of this product and related technology.
2. This product is guaranteed by the designated after-sales service unit.
3. Always start microdermabrasion treatment at lowest level until your skin is accommodated to it.
4. Microdermabrasion Machine is a high-precision electronic instrument, please keep and store it properly. Do not store it in a place that is damp, exposed to direct sunlight, or around with inflammable and explosive materials to prevent damage.
5. Please power off the instrument when not in use, and make sure to turn off the general power of the machine before leaving after daily use for safety reason.

Contraindications

Please do not use the machine or consult a doctor or professional before use if you:

1. Have sensitive skin or experience skin irritation.
2. Have facial implant.
3. With extensive facial trauma.
4. Suffer from skin disease or infectious diseases.
5. Recently had injections, such as hyaluronic acid, mesotherapy, botulinum, or plastic surgery.

Technical parameters

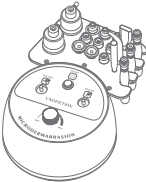
	Model:	SR-NF105U
	Voltage:	110V-220V 50HZ/60HZ
	Power:	8W
	Vacuum Suction:	-73KPa
	Air flow:	6PLM
	Noise level:	<65db(30cm away)
	Dimensions:	9.7 x 7 x 6 inch (250*178*150mm)
	Net weight:	1kg
	Gross weight:	1.3kg

Packing List



Main Machine x 1

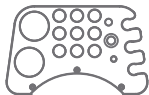

Rack x 1



Microdermabrasion Handle x 3

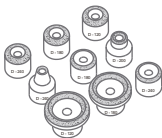

Microdermabrasion Tips x 9



Glass Tubes x 3



Spray Bottle x 2



Hose x 1



Cotton Filter x 1 Pack(50PCS)



Spare Rubber Rings x 6



User Manual x 1



Screws x 3



L-shaped Hexagon Wrench x 1



Adaptor x 1

Note: ⚠

Please inspect the device and its accessories for completeness before installation.

Control Panel Instruction

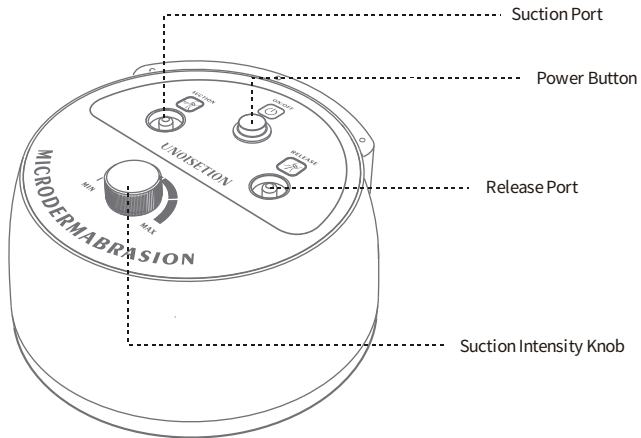

User Guide

1. Installation

1.1 Install the rack.



2.1 Connect the power.

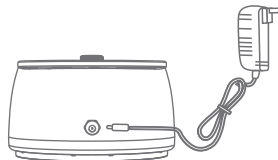



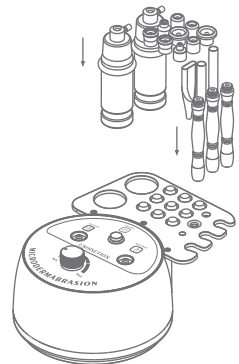



3.1 Place all the components as shown.

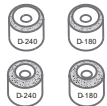

2. Microdermabrasion

2.1 How to Select the Microdermabrasion Tip?

<p>D-240 & D-180</p> 	<p>For large facial areas.</p>	
<p>D-240 & D-200</p> 	<p>For small areas around the eyes or nose.</p>	
<p>D-180 & D-120</p> 	<p>For large facial areas or body joints.</p>	

Note : ⚠

Do not use the microdermabrasion tip on the same spot for more than 3 seconds.
The higher the D number, the finer the grit. We recommend starting with the highest number.

2.2 How to Install the Microdermabrasion Handle and Tips?

1. Check the microdermabrasion handle for the pre-installed black rubber ring; if it's missing or damaged, replace it.

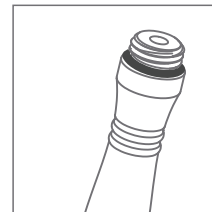

2. Put a cotton filter on the microdermabrasion handle port.

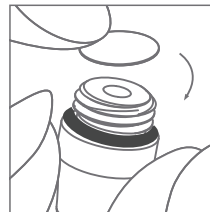

3. Attach the desired tip to the handle.

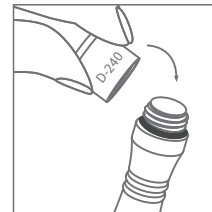

4. Connect one end of the hose to the handle.

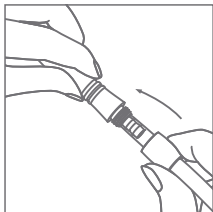

2.3 How to Clean Microdermabrasion Tip?

Clean the tip with water or soapy water after each use. Ensure to remove the microdermabrasion tip from the handle.

Note : ⚠

- ① Replace the tip every 3 months.
- ② Change the cotton filter in the tip every 3 sessions.

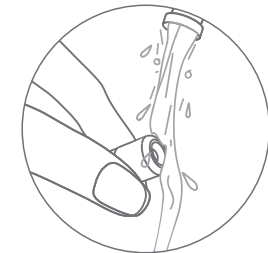
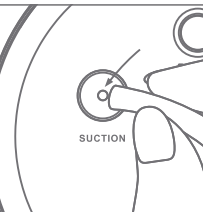

5.1 Connect the other end of the hose to the suction port on the main machine.

3. Glass Tube

3.1 How to Select the Glass Tube?

Flat Glass Tube: For facial massage.

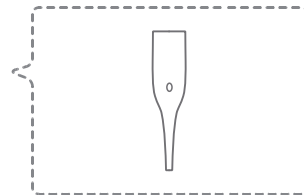

Straight Glass Tube: For clearing severely clogged pores.

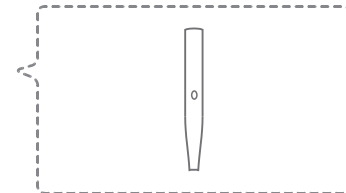

The bend glass tube for blackheads removal.

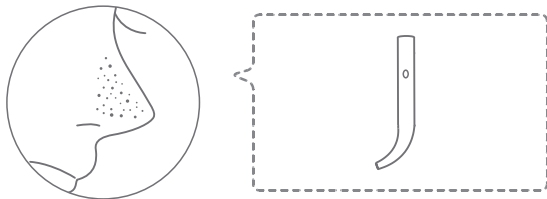

3.2 How to Install the Glass Tube?

1. Connect one end of the hose to the glass tube.

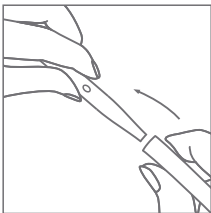

2. Attach the other end to the suction port on the main machine.

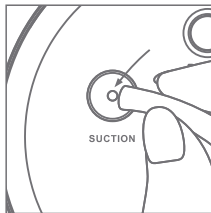

3.3 Caution ⚠

Cover the hole on the glass tube with your finger to prevent air leakage during use.

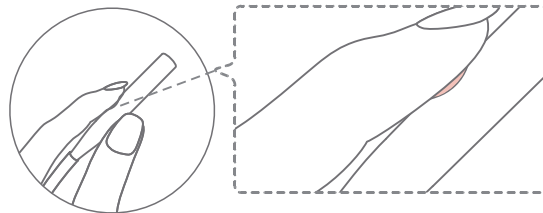

4. Spray Bottle

4.1 How to Install the Spray Bottle?

1. Add water and saline, serum, toner etc. into the spray bottle in a 10:1 ratio



3. Attach the other end to the spray bottle.



2. Connect one end of the hose to the release port on the main machine.

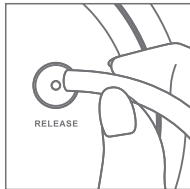

4. Cover the hole at the top of the bottle during use.



4.2 Precautions: ⚠

Avoid using high-concentration solutions.

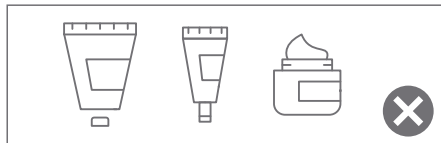

Recommended Application

1. Open pores with a facial steamer or hot towel.

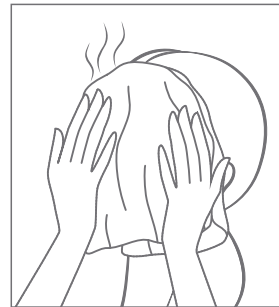

2. Power on the device.
The button lights up red when the microdermabrasion machine is in operation.

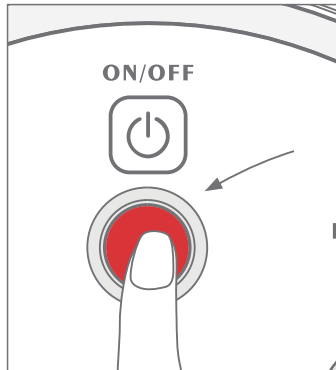

3. Adjust the suction intensity to a comfortable level.

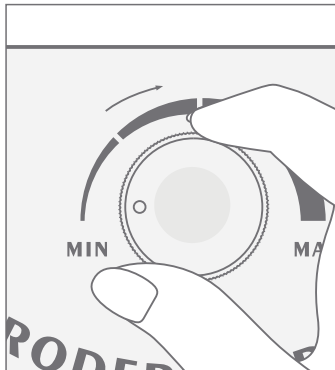

4. Exfoliate and reduce wrinkles with the microdermabrasion tip.



5. Remove comedones using the glass tube.

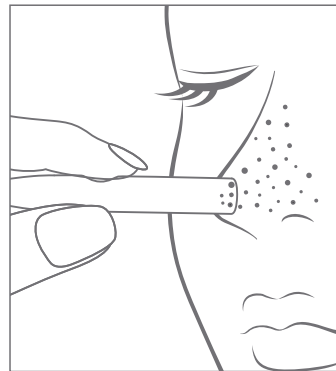

6. Hydrate the skin with the spray bottle.



7. Complete the procedure with a facial mask.

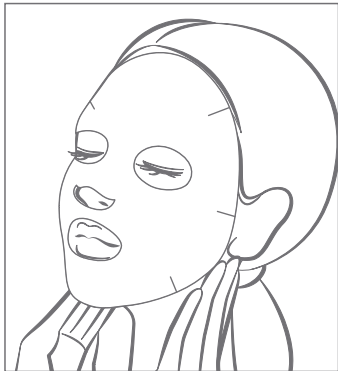

Troubleshooting

1. 1 No suction or weak suction from the device.

1. Verify if the pump is functioning; it should vibrate when operational.
2. Ensure the hose is properly connected according to the user manual.
3. Check if the rubber ring on the microdermabrasion wand is installed.
4. Confirm that the suction intensity knob is not set to the lowest level.
5. Inspect the hose for any damage, as a broken hose may cause air leakage.
6. For glass tube applications, cover the mini hole with your finger to generate suction.
7. Contact us if the device is malfunctioning.

1. 2 The device fails to work.

1. Ensure the power cord is securely and fully connected to the device.
2. Use only the adapter provided by the manufacturer.
3. If the power button is loose, contact us.
4. If the issue persists, contact us.

Note: ⚠

If the problem persists, please contact us for further assistance.

FAQ

1

Q: Why does my face get redness after Microdermabrasion?

A: Microdermabrasion Machine adopts the principle of negative vacuum pressure, when the microdermabrasion wand or glass tube is applied to your face, the capillaries of your face will be congested with blood, so the appearance of skin redness is normal. It should disappear in few hours.

2

Q: How long does it take to see results?

A: After the first treatment, you skin will be softer and smoother. After 8-12 weeks of continuous treatment, you may see a reduction in the appearance of fine lines, wrinkles, dark spots and hyperpigmentation.

3

Q: Why the Spray Bottle fails to spray?

A: ① It is possible that the concentration of the liquid in the bottle is too high, which causing the blockage.
② You are not pressing the top hole with your finger during use.

Warranty and Support

A one-year warranty is provided from the date of purchase.
If you have any questions or problems with the product, please contact us via email.
We are glad to provide you with additional skincare guidance.

Email: mychwayuk@outlook.com

Product Name: Microdermabrasion Machine
Product Model: SR-NF105U
Production Date: _____
Quality Inspection: _____

PASS