

# User Manual

Home SPA Instrument

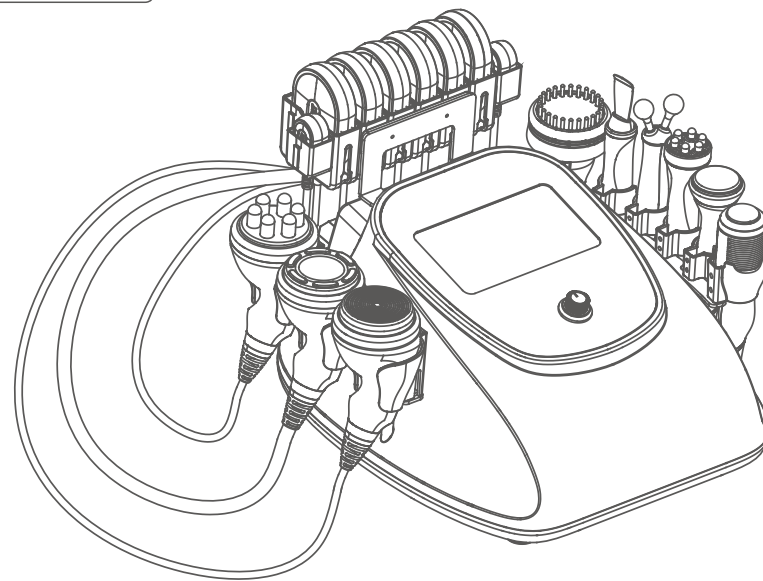

# Table of contents

Safety precautions ..... 1

Contraindications ..... 2

Overview ..... 2

Interface function ..... 3

Technical specification ..... 7

Precautions ..... 8

Maintenance & Cleaning ..... 9

FAQ ..... 9

Ask & Answer .....12

Operation guide .....13

Warranty & Support .....15

# Safety Precautions

- 1.Please read this manual carefully before use and familiarize yourself with the operation of this instrument and related technology.
- 2.This instrument is a high-precision electronic device that requires proper storage. Please avoid storing it in humid conditions, direct sunlight, or near flammables and explosives to prevent damage.
- 3.Always use the designated accessory provided or recommended by the manufacturer to ensure performance throughout its service life.
- 4.Do not place the instrument in high-temperature conditions, as this may negatively impact its service life and performance.
- 5.Do not apply the instrument on eyes, thyroid, parathyroid, testicles, pregnant women's abdomen, pacemakers, etc.
- 6.Patients should refrain from using this instrument unless they have obtained permission from their doctor.
- 7.Ensure that the instrument is applied on moist skin and avoid the operation on dry skin.
- 8.Power off the instrument when not in use to ensure its safety.
- 9.If you are currently taking weight-loss drugs, please discontinue their use 1 - 2 months before using this instrument. Failure to do so may result in an extended course of treatment.
- 10.To maintain hygiene and extend the instrument's service life, sterilize it with saline.

## Contraindications

Before using this instrument, it is essential to consult your doctor or seek advice from professionals. Details as below:

1. Pregnant or lactating woman.
2. Individuals with hypertension, heart disease, or a pacemaker installed.
3. Individuals with unhealed wounds or those in the recovery period from surgery.
4. Individuals who are sensitive to the micro-current.
5. Individuals suffering from epilepsy, severe diabetes, and hyperthyroidism.
6. Individuals suffering from malignant tumors, hemophilia, and hemorrhage.
7. Individuals with skin disease or infectious disease.
8. Individuals have had a cesarean section within six months, a miscarriage within three months, or a natural birth within two months.
9. For your safety, refrain from using if you've had plastic surgery or have implants/metal objects near the treatment area within 3 months.

## Overview

With the most popular and safest technology for anti-aging, firming skin, and body shaping, this 10-in-1 beauty instrument ensures you achieve your desired body figure. It provides the perfect solution for people seeking improvements in skin appearance and body figures without injections, drugs, or side effects. For external use with immediate effects.

## Interface function

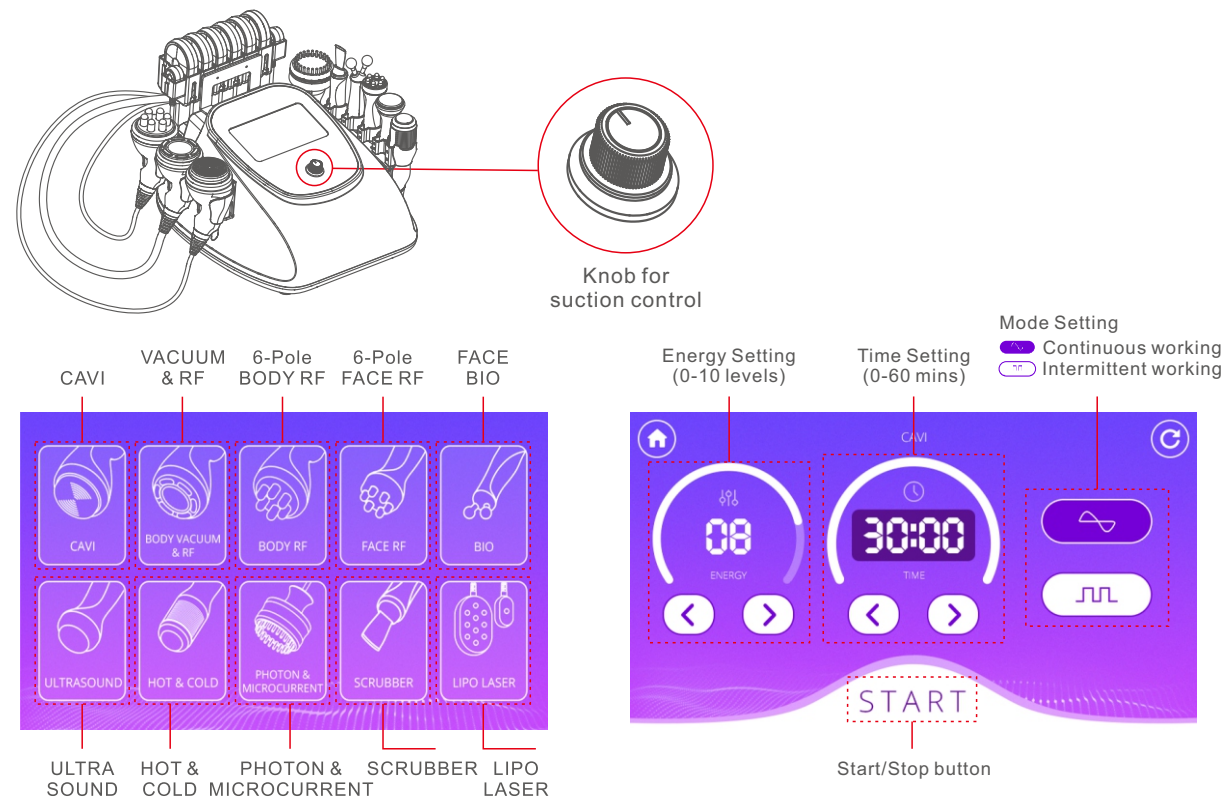

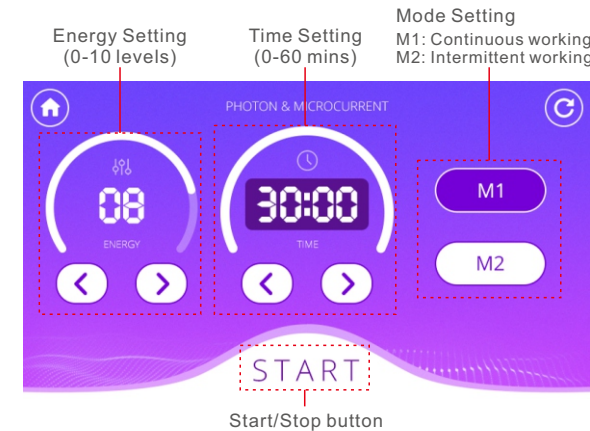
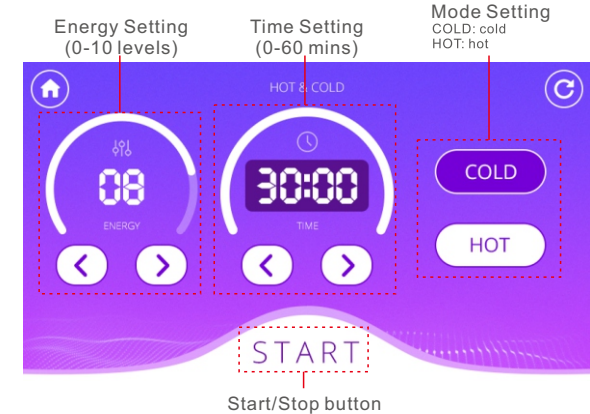
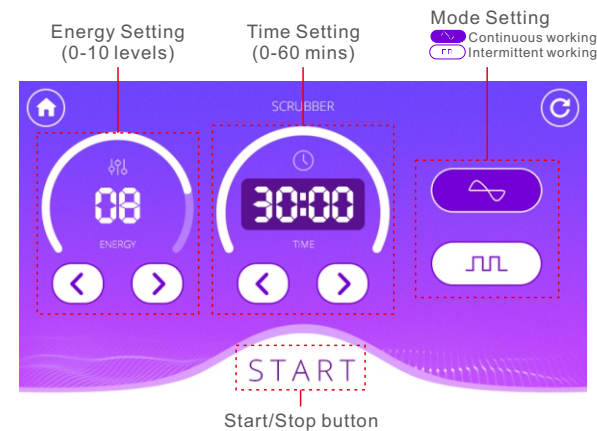
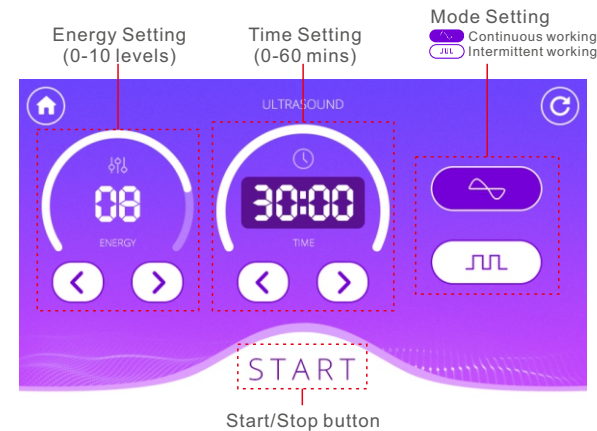
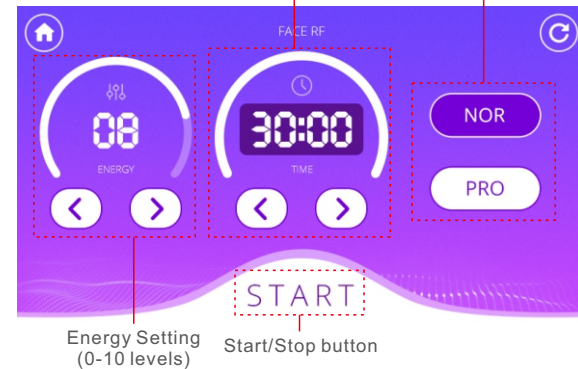
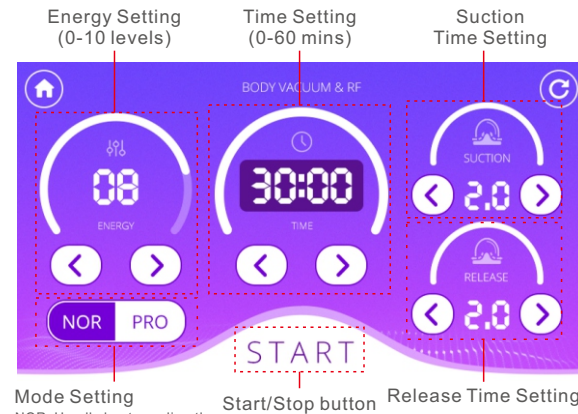
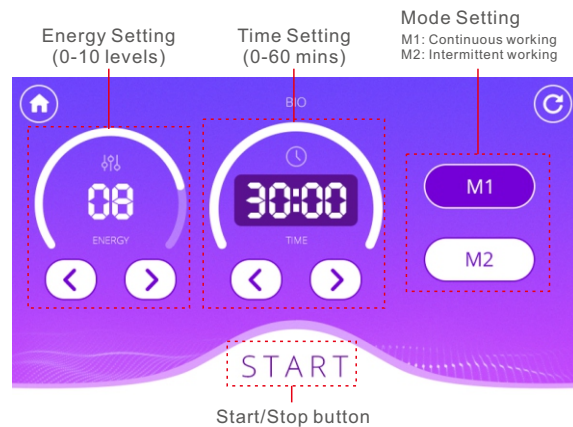
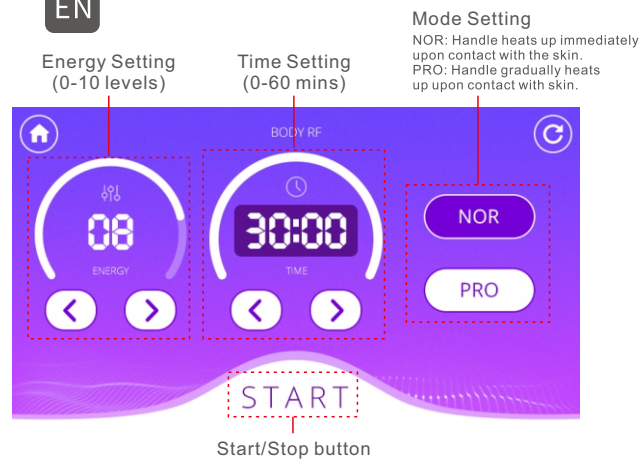

How to use the PHOTON&MICROCURRENT handle.

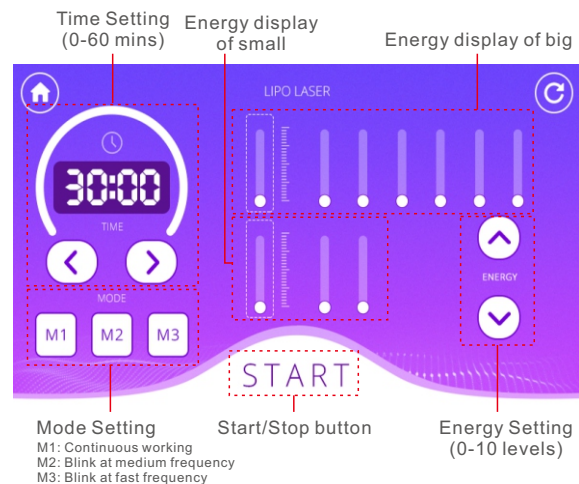
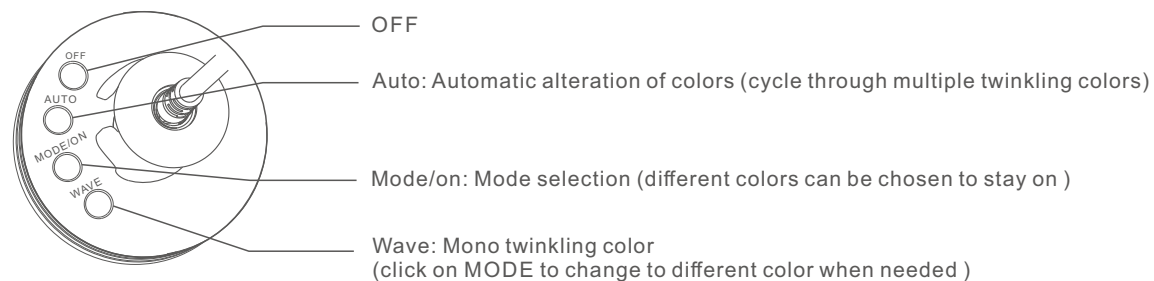

## Technical specification

	Power supply Input: AC110V-240V 50-60Hz		Net Weight: 8kg	
	Power:	66W	Gross Weight: 9.3kg	
	Dimensions:	17.6×18.1×10.2inches		
	Input Power:	66W		

	Frequency: 40000HZ		Frequency: 1MHZ	Air flow: 10LPM	Noise level: <6dB (30cm away)
	Power: 35W		Power: 66W		
	Vacuum: -77KPa				

	Frequency: 1MHZ		Frequency: 1MHZ		Frequency: 90KHZ
	Power: 50W		Power: 30W		Power: 9W

	Power: COLD 20W		Frequency: 1MHz		Frequency: 62.5HZ
	COLD: 32-39.2°F		Power: 18W		Power: 20W
	HOT: 113°F				

	Frequency: 62.5Hz		Wavelength:
	Power: 12W		Power: 13W

## Precautions

1. Strictly follow the instructions in the manual to use the instrument and train operator.
2. Before using the instrument, use a plug with a grounding pin and ensure the power socket is grounded.
3. Make sure the voltage of the instrument is adapted. If the local power supply voltage is unstable, we recommend adding a power-matched regulated power supply between the mains and the instrument.
4. Remove all the metal objects inside the body to avoid causing accidents or affecting treatment effects.
5. Stop the intake of weight drugs 1 - 2 months before the treatment, or extend the treatment course if you want to take the treatment immediately.
6. Do not use the instrument on an empty abdomen, and take the treatment 1 hour later after the meal.
7. Ensure full skin contact with the treatment head throughout the session to avoid uneven heat distribution.
8. Refrain from using the CAVI handle on areas such as the head, chest, breast, heart, or back.
9. Always start with the lowest vacuum intensity.
10. Ensure the filter cotton is installed inside the vacuum handle, as the foreign body may block the handle.
11. During Hot&Cold treatment try to avoid air vents, as the bad heat dissipation may affect the service life of the instrument.
12. Fix the laser pads on the treated individual first, then switch on the instrument, and gradually adjust the energy intensity from low to high to ensure a warm and comfortable experience for the user.
13. Maintain complete contact between the laser pad surface and skin, avoiding partial contact.
14. The combination of the laser pad with massage or other handle contributes to better result. In case use the laser pad alone, fix the pads to the fat area and wait for around 30 minutes.
15. Before beginning the microcurrent treatment, kindly inform the customer about the sensations associated with microcurrent to prevent any unnecessary concerns or discomfort.

## Maintenance & Cleaning

1. Disconnect the power cord when not in use and store the instrument in a dry, cool, and well-ventilated place.
2. Clean and sanitize the handle with a damp cloth or saline, and then dry it thoroughly with a dry towel to ensure it remains dry.
3. Before cleaning the Vacuum & RF handle, ensure to remove the filter cotton to prevent the growth of bacteria.
4. After cleaning the instrument, cover it with a dustcloth or plastic wrap. Before use, ensure to sanitize the handle again for hygienic reasons.
5. Disassembling the instrument and attempting to clean the inside is strictly prohibited. This task should only be performed by professionals.

## FAQ

1. Why do I need exfoliation?

A: The stratum corneum is the outermost layer of the epidermis, consisting of 15 – 20 layers of dead cells that can vary from different parts of the human body. The skin's metabolism cycle also varies among individuals of different ages. For example, the cycle is 28 days for teenagers, whereas for adults, it is the sum of their age plus 10. However, for a variety of reasons, the stratum corneum might not shed in a timely manner, resulting in an increased thickness of the stratum corneum, a dull complexion, and an impact on skin metabolism. In such cases, additional exfoliation is necessary.

2. How does the Ultrasound Scrubber achieve deep skin cleansing?

A: The ultrasound Scrubber utilizes ultrasound and high-frequency vibration to atomize water and deliver it into pores deeply, emulsifying and removing impurities like makeup residue.

This process achieves the effect of deep cleansing without expanding pores.

3. How long does it take to see the results of RF treatment?

A: You might experience skin tightness right after the treatment, as the heat stimulation tightens the collagen tissue, and the RF stimulates the subcutaneous tissue bringing the continuous regeneration of collagen, leading to more noticeable results within one week.



#### 4. Is RF safe for the skin?

A: RF firming and anti-wrinkle treatment is a non-surgical method that stimulates collagen regeneration and metabolism in the deeper layers of the skin without causing any harm. It's normal to experience temporary heat and redness in the treated area, which indicates increased blood circulation and should subside within a few hours. There's no need to be concerned about this reaction.

#### 5. What is the duration of a body sculpting treatment?

A: Approximately 60 minutes, our skilled techniques and advanced instrument guarantee impressive results.

#### 6. Liposuction or our device?

A: Liposuction surgery utilizes negative pressure to remove excess fat from specific areas, resulting in a slimming effect. It provides you with immediate results, but it also carries risks, requires anesthesia, and involves downtime. While our device offers a risk-free solution with no side effects. It sculpts your body, stimulates collagen regeneration for lifted skin, and creates the ideal figure for an overall improved appearance.

#### 7. Is it safe to use ultrasound on the entire body?

A: NO. Ultrasound can break down fat cells, causing the cell walls to rupture and releasing fat, which is then absorbed and metabolized by the lymphatic system. The power of ultrasound is quite strong, and the heart is particularly sensitive to sound waves due to being a hollow organ. Sound waves can cause vibrations in the heart, and there can be variations in how sound waves are conducted through muscle tissue and blood within the heart, resulting in back-and-forth reflections. As a consequence, the valve may become dislodged from the heart muscle. Certainly, ultrasound treatment should be strictly avoided around the eye area to prevent the risk of retinal detachment, as well as areas such as the waist, back, chest, and the region around the heart.

#### 8. Are there any side effects of ultrasound on the human body?

A: High-frequency sound wave is a non-surgical, non-invasive procedure that does not require incision or anesthesia. How does the ultrasound work: ultrasound (mechanical wave) - cavitation blasting - ultrasound focussing. The effect: fat breaking - fat dissolving - skin tightening and body sculpting, therefore, it only targets the low-density fat tissue and protects the high-density tissue such as blood vessels and nerves, ensuring no adverse effects on the human body. You may notice a slight noise in your ears during the session, which is a normal occurrence and requires no cause for concern.

#### 9. Why do I get tinnitus during the treatment?

A: When the ultrasound with concentrated energy vibrates strongly and has a frequency higher than 20Khz, it can penetrate the skin to reach the fat layer that is 20mm deep. The energy causes high-speed friction and heat among the fat cells, which breaks them down and emulsifies them. However, this process can create noise that may be audible in your ears.

#### 10. What is collagen?

A: Collagen is a biological polymer substance, a white opaque fibrous protein without branched chains, which can replenish essential nutrients needed by all layers of the skin and enhance the collagen activity in the skin, with the effects of locking moisture, moisturizing the skin, delaying aging, improving facial laxity and hair care. Collagen is an essential nutrient for promoting anti-aging effects. As you age, the gradual loss of collagen in your skin becomes evident. Typically, a woman's skin starts showing signs of aging around the age of 20 due to collagen depletion, and the rate of loss peaks at 25. Research suggests that by the age of 40, collagen levels are only about half of what they were at 18. The reduction in collagen and moisture content can contribute to the development of facial folds and wrinkles. This is primarily due to the breakdown of collagen fibers and elastic networks that support the skin. This loss also leads to oxidation, atrophy, and collapse of skin tissue, resulting in various signs of aging such as dehydration, wrinkles, looseness, and lack of elasticity.

#### 11. Will I regain weight after the lipolaser treatment?

A: The number of adipose cells in an adult remains constant, and weight gain is typically due to an increase in the size of these cells. This treatment employs a specific laser to stimulate adipose cells, leading them to release stored fatty acids and triglycerides, thereby reducing cell volume. Consequently, the occurrence of fat returning is highly unlikely. Additionally, maintaining a healthy diet would greatly contribute to preventing it.

## Ask & Answer

Ask	Cause	Answer
1. Instrument fails to turn on?	→ The power cord is disconnected to the wall socket.	→ Check if the power cord is well connected to the wall socket and ensure that the socket is functional.
	→ The fuse is loose or burned.	→ Replace the fuse on the back of the instrument and restart it.
2. The instrument is not working and can't be restarted?	→ The fuse may have burned out due to unstable voltage or prolonged use.	→ Please replace the fuse and restart the instrument 5 minutes later.
3. The screen shows an error message.	→ Data error.	→ 1. Turn off the instrument, disconnect the power cord, and wait for 1 minute to restart the instrument. 2. If the above method doesn't resolve the problem, please contact your dealer for a replacement.
4. The RF is not functioning.	→ The handle is not properly connected.	→ Please confirm if the handle plug is well connected to the main unit.
	→ Oil on the treatment area could result in insufficient contact between the handle and the body.	→ Apply some gels to the treatment area after cleaning.
	→ The handle is not contact with the body properly.	→ Ensure complete contact between the treatment head and the skin.
5. CAVI handle is not functioning.	→ You might mistakenly think that the handle is not functioning properly due to its low-noise design.	→ To check if the handle is functioning, please refer to the CAVI handle pretest.
	→ You may have forgotten to apply the gel or have used a product that is not designed for use with the instrument.	→ Please use the professional gel for CAVI treatment.
	→ Insufficient pressure.	→ Press harder during the CAVI handle application.

## Operational guidance

Face (Step1:  3mins > Step2:  7mins > Step3:  5mins > Step4:  5mins > Step5:  5mins )



Eye (Step1:  10mins )



Arm (Step1:  15mins > Step2:  15mins > Step3:  15mins )

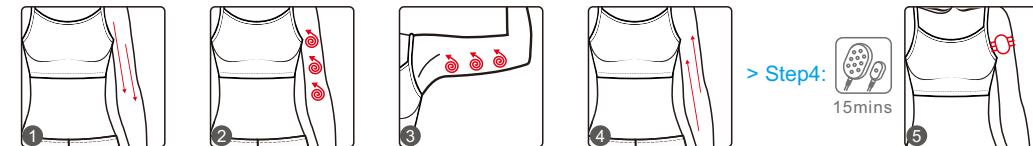

> Step4:  15mins



Belly (Step1:  15mins > Step2:  15mins > Step3:  15mins )

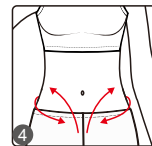
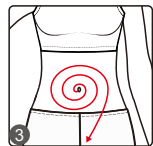
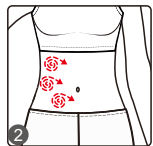
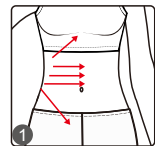

> Step4:  15mins

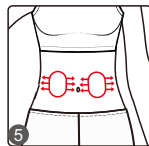

Back (Step1:  15mins > Step2:  15mins )

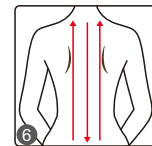
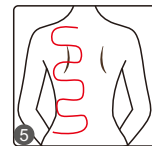
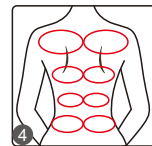
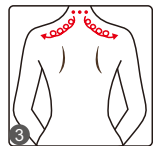
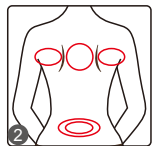
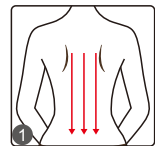

Leg (Step1:  20mins > Step2:  20mins )

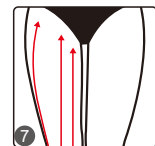
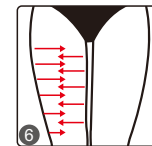
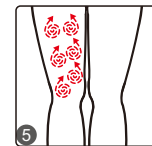
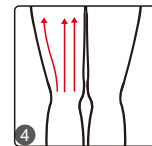
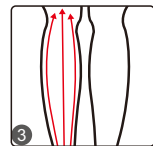
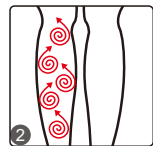
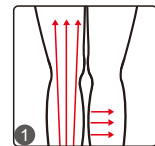

> Step3:  20mins

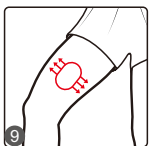

## Warranty & Support

We offer a one-year warranty on the main unit and a three-month warranty on components.

Product Name: Versatile Beauty Device  
 Product Model: SD-9XS1SB  
 Production Date: \_\_\_\_\_  
 Quality Inspection: \_\_\_\_\_

PASS