

User Manual

UNOISETION Microdermabrasion Machine

MS-12P1

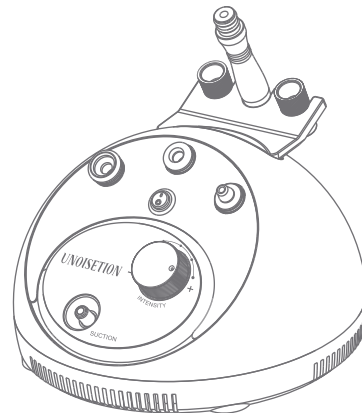

Table of contents

Overview	1
Benefits	1
Packing List	2
Control Panel Instruction	3
User Guide	4
Recommended Routine	12
Troubleshooting	15
FAQ	15
Precautions	17
Contraindications	17
Technical Parameters	18
Warranty and Support	19

Overview

Thank you for choosing UNOISETION Microdermabrasion Machine!
Please read this manual carefully before use!

Featuring fine particles on the microdermabrasion tip, this device gently exfoliates the thick, uneven skin on the surface and removes it through suction, promoting skin revitalization. Follow with the probe to extract impurities from the pores using negative pressure for a deep cleansing effect.

Benifits

1. Removes age spots and unclogs pores
2. Improves hyperpigmentation
3. Exfoliates and rejuvenates the skin
4. Reduces fine lines and wrinkles
5. Minimizes or eliminates enlarged pores
6. Reduces comedones

Packing List



Main Machine x 1



Microdermabrasion Tips x 3



Cotton Filter x 1 Pack(50PCS)



Hose x 1



Probe x 2



Spare Rubber Rings x 8



Microdermabrasion Handle x 1



Box x 1



Adaptor x 1



Cleaning Brush x 1



User Manual x 1

Note: ⚠

Please inspect the device and its accessories for completeness before installation.

Control Panel Instruction

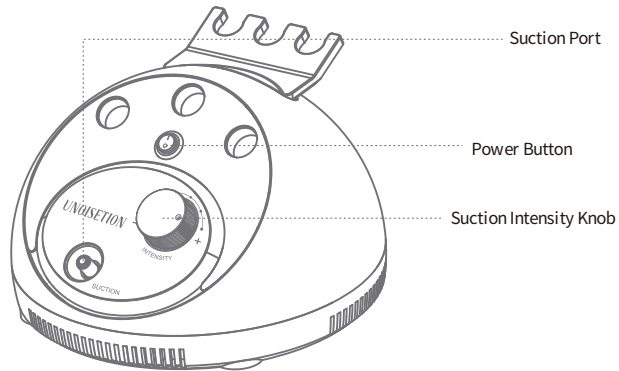

Suction Port

Power Button

Suction Intensity Knob

User Guide

1. Installation

1. Connect the power.

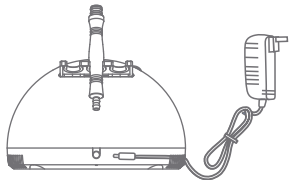



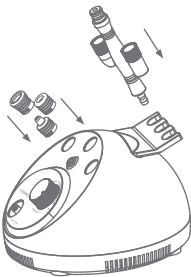

2. Place all the components as shown.



2. Microdermabrasion

2.1 How to Select the Microdermabrasion Tip?

	For large facial areas.	
	For small areas around the eyes or nose.	

Note : ⚠

Do not use the microdermabrasion tip on the same spot for more than 3 seconds.

2.2 How to Install the Microdermabrasion Handle and tips?

1. Check the microdermabrasion handle for the pre-installed White rubber ring; if it's missing or damaged, replace it.

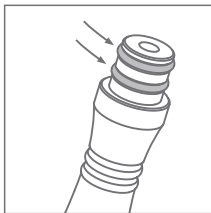

2. Put a cotton filter on the microdermabrasion handle port.

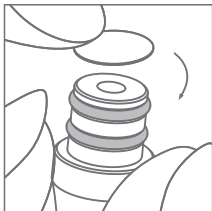

3. Attach the desired tip to the handle.

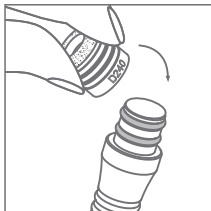

4. Connect one end of the hose to the handle.

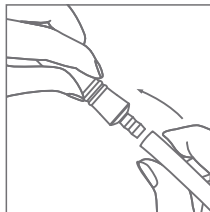

5. Connect the other end of the hose to the suction port on the main machine.

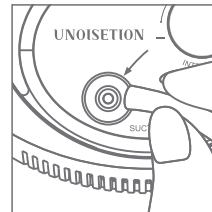

2.3 How to Clean Microdermabrasion Tip?

Clean the tip with water or soapy water after each use. Ensure to remove the microdermabrasion tip from the handle.

Note : ⚠

- ① Replace the tip every 3 months.
- ② Change the cotton filter in the tip every 3 sessions.

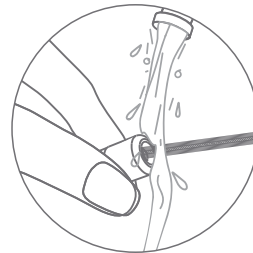

3. Probe

3.1 How to Select the Probe?

Round Probe: Remove Blackhead on the nose.

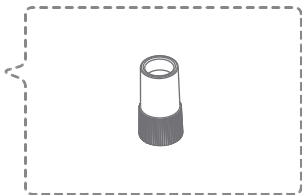

Oval Probe: Remove dead skin cell for smooth.

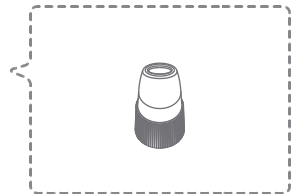
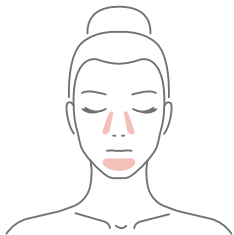

3.2 How to Install the Probe?

1. Check the microdermabrasion handle for the pre-installed White rubber ring; if it's missing or damaged, replace it.

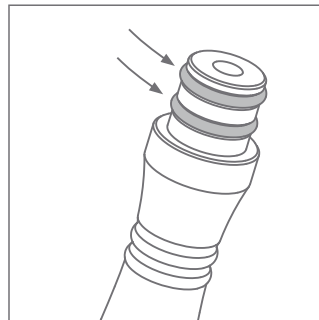

2. Put a cotton filter on the microdermabrasion handle port

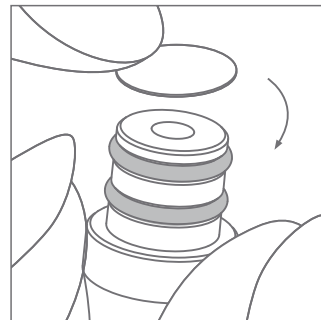

3. Attach the desired probe to the handle.

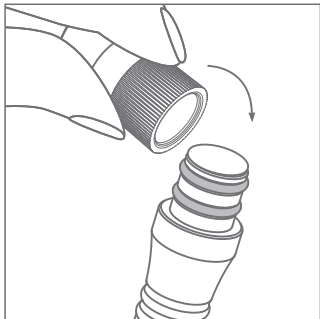

4. Connect one end of the hose to the handle.

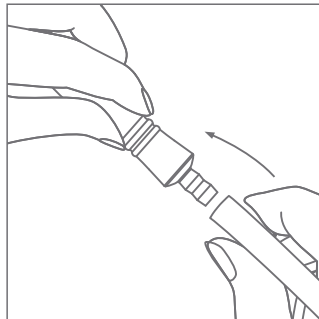

5. Connect the other end of the hose to the suction port on the main machine.

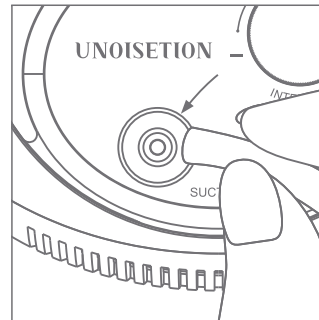

3.3 How to Clean Probe ?

Clean the probe with water or soapy water after each use. Ensure to remove the probe from the handle.

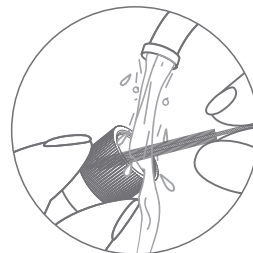

Note : ⚠

- ① Replace the probe every 3 months.
- ② Change the cotton filter in the probe every 3 sessions.

Recommended Routine

1. Open pores with a facial steamer or hot towel.

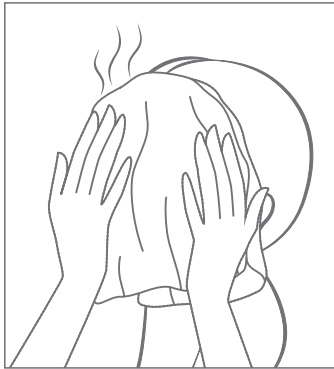

2. Power on the device.
The button lights up red when the microdermabrasion machine is in operation.

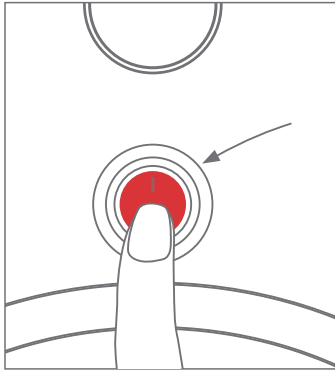

3. Adjust the suction intensity to a comfortable level.

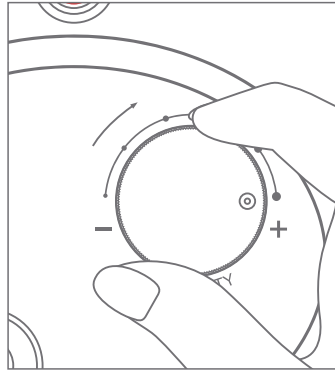

4. Exfoliate and reduce wrinkles with the microdermabrasion tip.

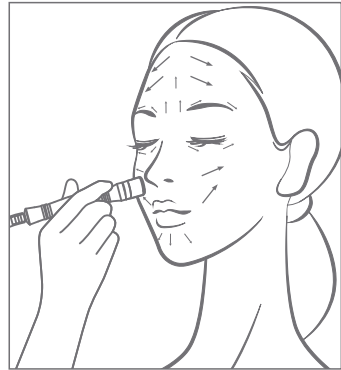

5. Remove Blackhead using the probe.

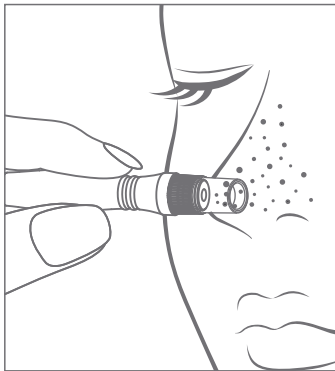

6. Complete the procedure with a facial mask.

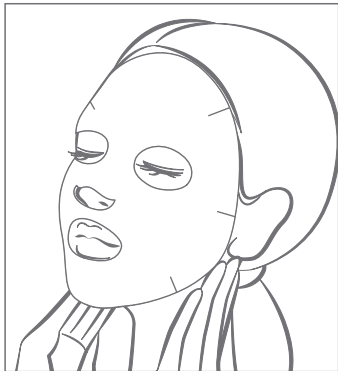

Troubleshooting

1. 1 No suction

1. Check if the hose is properly installed in the suction port.
2. Ensure the hose is tightly connected to the handle.
3. Inspect the rubber ring; if missing or damaged, replace it.
4. Check the hose for any damage; replace if necessary.

Note: ⚠

If the problem persists, please contact us for further assistance.

FAQ

1

Q: Why does my face get red after Microdermabrasion?

A: Microdermabrasion works on the principle of negative vacuum pressure. When the microdermabrasion tip or probe is applied to your skin, it can cause temporary capillary congestion, resulting in redness. This is normal and should fade within a few hours. It is recommended to moisturize your skin with facial cream after using the microdermabrasion tip or probe.

2

Q: How long does it take to see results?

A: After the first session, your skin will feel softer and smoother. With consistent treatment over 8-12 weeks, you may notice visible improvements in fine lines, wrinkles, spots, and hyperpigmentation.

3

Q: How often should I use the Microdermabrasion Machine, and how long should each session be?

A: It is recommended to use the Microdermabrasion Machine 1–2 times per week, with each session lasting 15–30 minutes. Adjust the frequency and duration based on your skin type and personal expectations.

4

Q: Which skin types are suitable for the Microdermabrasion Machine?

A: The Microdermabrasion Machine is suitable for all skin types, including normal, dry, oily, and combination skin. However, individuals with sensitive skin or other skin concerns should consult a professional doctor or therapist for advice.

Precautions

1. Please read this manual carefully before use so you are familiar with the use of this product and related technology.
2. This product is guaranteed by the designated after-sales service unit.
3. Always begin microdermabrasion treatments at the lowest level until your skin adjusts to the treatment.
4. The Microdermabrasion Machine is a high-precision electronic instrument, please keep and store it properly. Do not store it in a place that is damp, exposed to direct sunlight, or around with inflammable and explosive materials to prevent damage.
5. Power off the instrument when not in use, and ensure the general power is turned off after daily use for safety reasons.

Contraindications

Please do not use the machine or consult a doctor or professional before use if you:

1. Have sensitive skin or experience skin irritation.
2. Have facial implant.
3. With extensive facial trauma.
4. Suffer from skin disease or infectious diseases.
5. Recently had injections, such as hyaluronic acid, mesotherapy, botulinum, or plastic surgery.

Technical Parameters

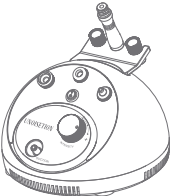
	Model: MS-12P1			
	Voltage:	110V-240V	Frequency:	50Hz/60Hz
	Power:	5W	Noise:	< 65dB
	Dimensions:	6.69 x 6.69 x 4.82 inch (170*170*120mm)		
	Gross Weight:	1.1kg(2.43lb)		
	Net weight:	0.8kg(1.76lb)		

Warranty and Support

A one-year warranty is provided from the date of purchase. If you have any questions or issues with the product, please contact us via email. We are glad to provide you with additional skincare guidance.

Email: unoisetion@gmail.com

Product Name: Microdermabrasion Machine
 Product Model: MS-12P1
 Production Date: _____
 Quality Inspection: _____

PASS