

User Manual

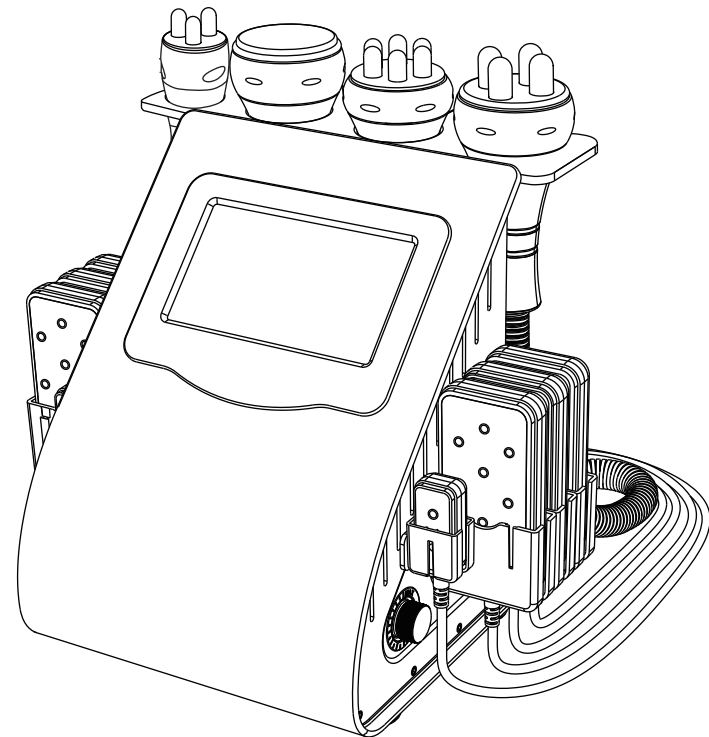

Content

1.Safety Precautions	1
2.Contraindications	1
3.Overview	2
4.Control Panel Introduction.....	3
5.Technical Specification	11
6.Use Precautions	12
7.Maintenance & Cleaning.....	13
8.FAQ	13
9.Ask & Answer	16
10.Operation Guide	19
11.Warranty & Support	24

1.Safety Precautions

- 1.Please read this manual carefully before use and familiarize yourself with the operation of this instrument and related technology.
- 2.This instrument is a high-precision electronic device that requires proper storage. Please avoid storing it in humid conditions, direct sunlight, or near flammables and explosives to prevent damage.
- 3.Always use the designated accessory provided or recommended by the manufacturer to ensure performance throughout its service life.
- 4.Do not place the instrument in high-temperature conditions, as this may negatively impact its service life and performance.
- 5.Do not apply the instrument on eyes, thyroid, parathyroid, testicles, pregnant women's abdomen, pacemakers, etc.
- 6.Patients should refrain from using this instrument unless they have obtained permission from their doctor.
- 7.Ensure that the instrument is applied on moist skin and avoid the operation on dry skin.
- 8.Power off the instrument when not in use to ensure its safety.
- 9.If you are currently taking anti-adiposity drugs, please discontinue their use for 1 - 2 months before using this instrument. Failure to do so may result in an extended course of treatment.
- 10.To maintain hygiene and extend the instrument's service life, sterilize it with saline.

2.Contraindications

Before using this instrument, it is essential to consult your doctor or seek advice from professionals. Details below:

1. Pregnancy or lactation.
2. Hypertension, heart disease, or with a pacemaker installed.
3. Unhealed wounds or during the recovery phase of surgery.
4. Epilepsy, severe diabetes, and hyperthyroidism.
5. Malignant tumors, hemophilia, and hemorrhage.
6. Skin disease or infectious disease.
7. Cesarean section within the last six months, a miscarriage within the last three months, or a natural birth within the last two months.
8. Had plastic surgery within 3 months or with implants or metal objects in the treatment area.

3. Overview

Harnessing the most favored and safest technology, this 6-in-1 Versatile beauty instrument offers holistic enhancements, encompassing skin tightening and body sculpting, guaranteeing a radiant metamorphosis for your body. It provides the perfect solution for people seeking improvements in skin appearance and body figures without injections, drugs, or side effects. Its external application yields immediate results.

4. Control Panel Introduction

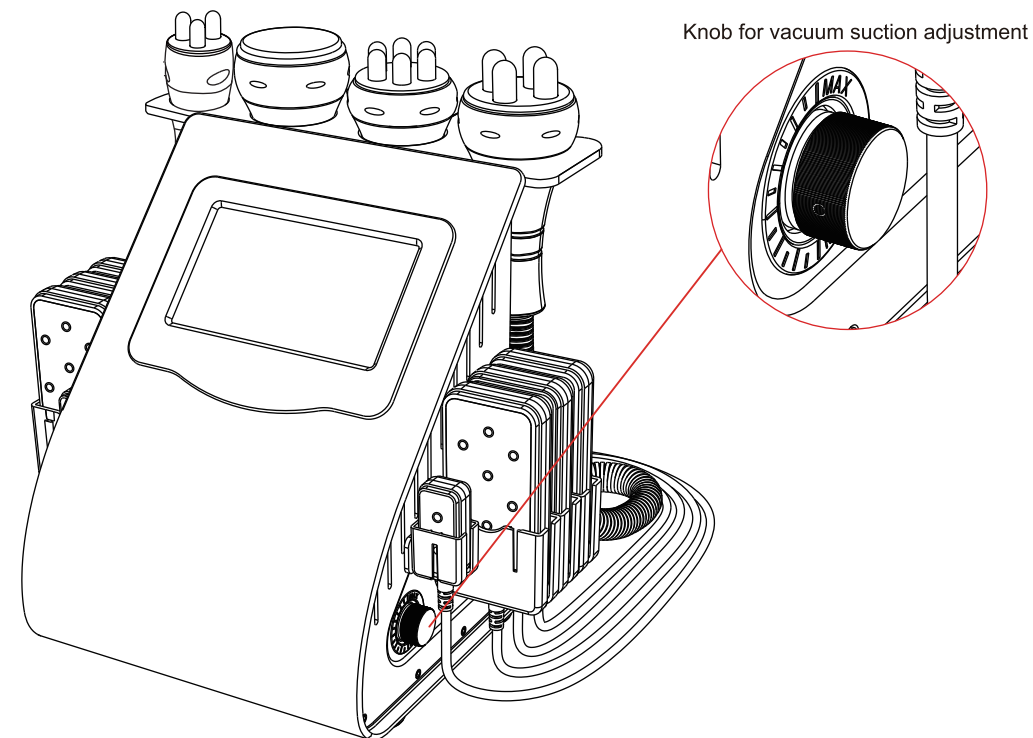

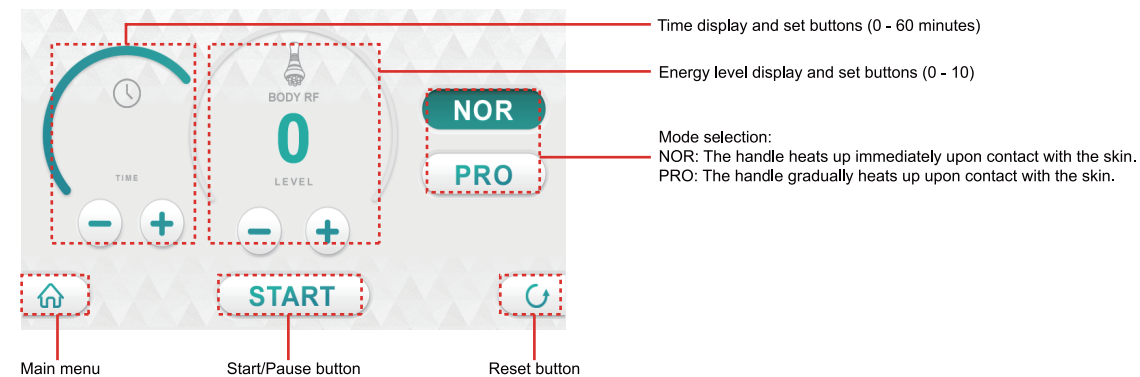
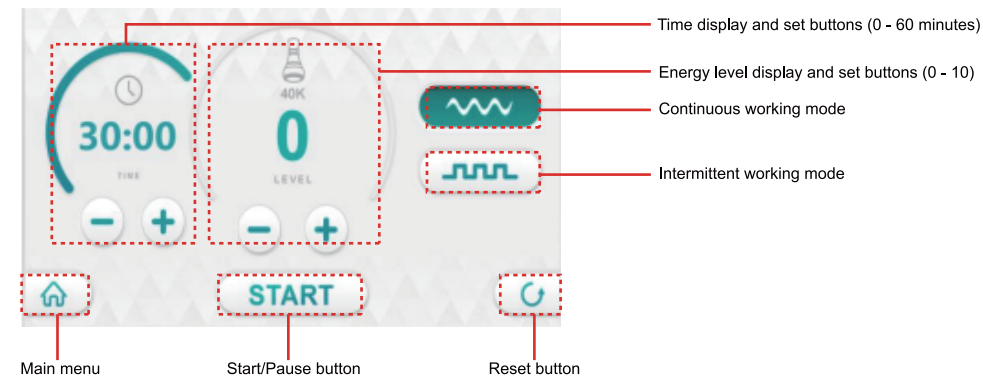
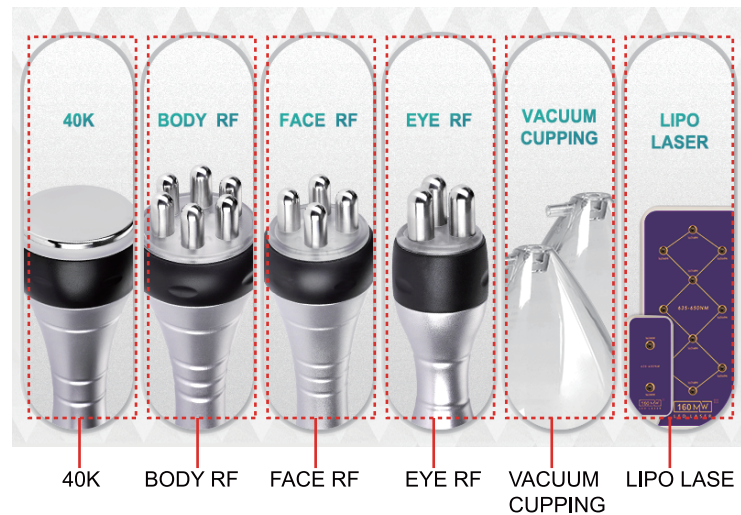



Main menu

Start/Pause button

Reset button

Time display and set buttons (0 - 60)

Energy level display and set buttons (0 - 10)

Mode selection:

NOR: The handle heats up immediately upon contact with the skin.

PRO: The handle gradually heats up upon contact with the skin.

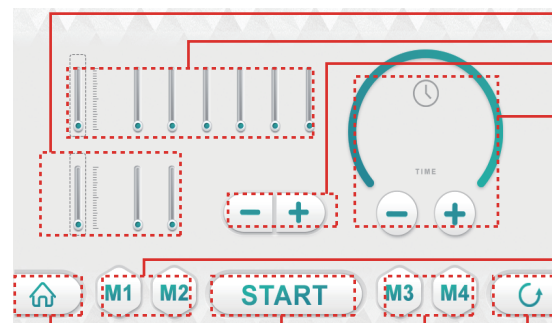

Main menu

Start/Pause button

Reset button

Energy level of the small laser pad

Energy level of the big laser pad

Energy level set buttons (0 - 10)

Time display and set buttons (0 - 60 minutes)

Mode selection:

M1: The lights are continuously illuminated.

M2: The lights blink at a slow pace.

M3: The lights flash at a moderate speed.

M4: The lights blink rapidly.

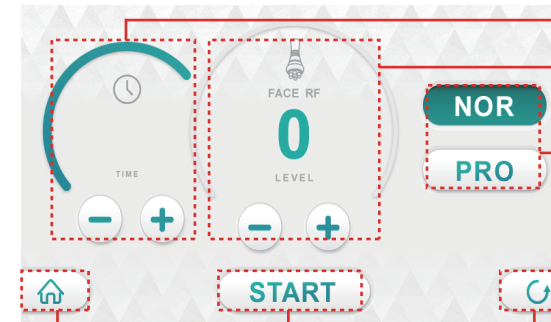

Main menu

Start/Pause button

Reset button

Time display and set buttons (0 - 60 minutes)

Energy level display and set buttons (0 - 10)

Mode selection:

NOR: The handle heats up immediately upon contact with the skin.

PRO: The handle gradually heats up upon contact with the skin.

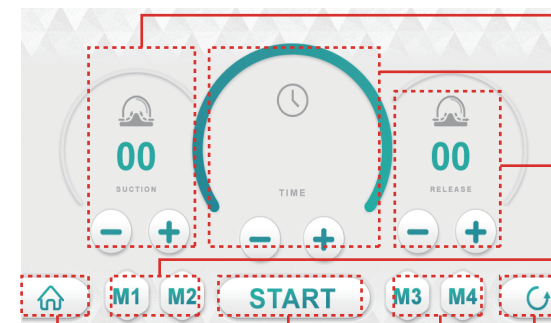

Main menu

Start/Pause button

Reset button

Suction time display and set button

Time display and set buttons (0 - 10 minutes)

Release time display and set buttons

Mode selection:

M1: only suction

M2: At a slow intermittent frequency

M3: At a fast intermittent frequency

M4: At the fastest intermittent frequency

Connect the transparent hose



The wide Y-shaped hose is designed for vacuum cup use.



The narrow Y-shaped hose is designed for breast cup use.



The straight hose is designed for grease cup use.

How to connect the wide/narrow Y-shaped hose:

connect one end of the hose to the inlet on the main unit, and connect another two ends with two vacuum cups/breast cups.

(In case only one cup is needed for the treatment, tie a knot on the spare end. And untie the knot if 2 cups are needed for the treatment.)

How to connect the straight hose:

connect one end of the hose to the inlet on the main unit, and connect another end with the grease cup.

How to choose the breast cup/vacuum cup/grease cup

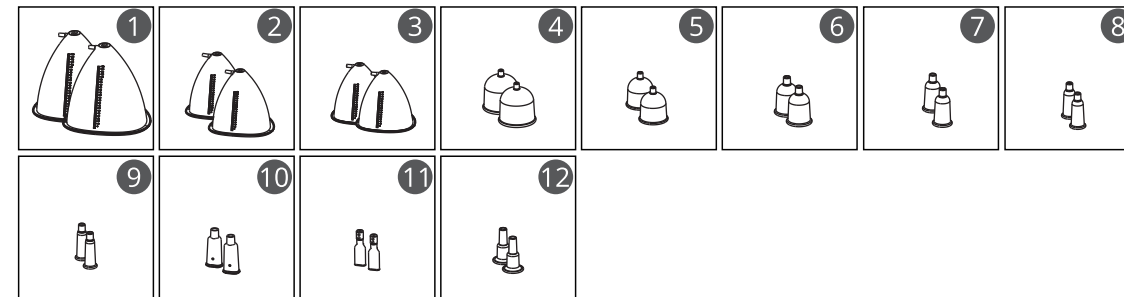

Cup No. 1 is suitable for individuals with larger-sized breasts who seek firmer and sculpted breasts.

Cup No. 2 is suitable for individuals with normal-sized breasts who desire firmer and more augmented breasts.

Cup No. 3 is suitable for individuals with smaller-sized breasts who want to enjoy a massage and relaxation.

Cup No. 4 is used for cupping therapy, moving cupping therapy (for large body areas, e.g., thighs, buttocks, abdomen)

Cup No. 5 is used for cupping therapy, moving cupping therapy (for body areas like legs, and back)

Cup No. 6 is used for cupping therapy, moving cupping therapy (for small body areas, e.g., arms, lower legs)

Cup No. 7 is used for moving cupping therapy (for body areas like the neck, and arms)

Cup No. 8 is used for moving cupping therapy, massage (for body areas like the face, and neck)

Cup No. 9 is used for moving cupping therapy, cleansing (for face area)

Cup No. 10 is used for the secret area.

Cup No. 11 is used for facial cleansing.

Cup No. 12 is used for cleansing or moving cupping therapy.

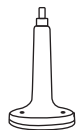
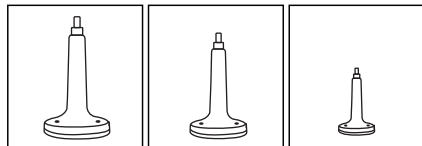

The large cup is used for large body areas, such as arms, abdomen, abdomen, waist, buttocks, legs, and back.

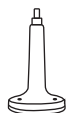



The medium cup is used for the face or parts of the body area, such as arms, neck, face, and lower legs.



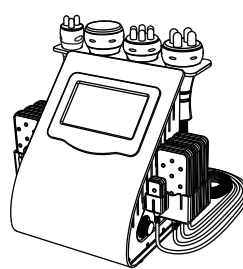

The small cup is used for the facial area, such as cheeks, around the eyes, forehead, chin, and neck.

5. Technical Specification

	Power supply Input: AC110V-240v 50HZ-60Hz		Net Weight: 6.88KG	
	Power: 66W		Gross Weight: 7.68KG	
	Dimensions: 30×27×36cm			
	Input Power: 66W			

	Power: 31W		Power: 66W
---	------------	---	------------

	Power: 53W		Power: 32W
---	------------	---	------------

6. Use Precautions

1. Strictly follow the instructions in the manual to use the instrument and train operator.
2. Before using the instrument, use a plug with a grounding pin and ensure the power socket is grounded.
3. Make sure the voltage of the instrument is adapted. If the local power supply voltage is unstable, we recommend adding a power-matched regulated power supply between the mains and the instrument.
4. Remove all the metal objects inside the body to avoid causing accidents or affecting treatment effects.
5. Stop the intake of anti-adiposity drugs 1 - 2 months before the treatment, or extend the treatment course if you want to take the treatment immediately.
6. Refrain from using the instrument on an empty stomach, and initiate the treatment one hour after a meal.
7. Ensure full skin contact with the treatment head throughout the session to avoid uneven heat distribution.
8. Refrain from using the 40K handle on areas such as the head, chest, breast, heart, or back.
9. Always start with the lowest suction intensity, and increase it gradually.
10. Fix the laser pads on the treated individual first, then switch on the instrument, and gradually adjust the energy intensity from low to high to ensure a warm and comfortable experience for the user.
11. Maintain complete contact between the laser pad surface and skin, avoiding partial contact.
12. The combination of the laser pad with massage or other handles contributes to better results. Alternatively, you can use the laser pads alone. Simply fix them in the treatment area and wait for 20 minutes.

7. Maintenance & Cleaning

1. Disconnect the power cord when not in use and store the instrument in a dry, cool, and well-ventilated place.
2. Clean and sanitize the applicator with a damp cloth or saline, and then dry it thoroughly with a dry towel to ensure it remains dry.
3. After cleaning the instrument, cover it with a dustcloth or plastic wrap. Before use, ensure to sanitize the handle again for hygienic reasons.
4. Disassembling the instrument and attempting to clean the inside is strictly prohibited. This task should only be performed by professionals.

8. FAQ

1. How long does it take to see the results of RF treatment?

A: You might experience skin tightness right after the treatment, as the heat stimulation tightens the collagen tissue, and the RF stimulates the subcutaneous tissue bringing the continuous regeneration of collagen, leading to more noticeable results within one week.

2. Is RF safe for the skin?

A: RF firming and anti-wrinkle treatment is a non-surgical method that stimulates collagen regeneration and metabolism in the deeper layers of the skin without causing any harm. It's normal to experience temporary heat and redness in the treated area, which indicates increased circulation and should subside within a few hours. There's no need to be concerned about this reaction.

3.What is the duration of a body sculpting treatment?

A: Approximately 60 minutes, our skilled techniques and advanced instruments guarantee impressive results.

4.Liposuction or this device?

A: Liposuction surgery utilizes negative pressure to remove adipose tissue accumulations from specific areas, resulting in a body-shaping effect. It provides you with immediate results, but it also carries risks, requires anesthesia, and involves downtime. While our device offers a risk-free solution with no side effects. It sculpts your body, stimulates collagen regeneration for lifted skin, and creates the ideal figure for an overall improved appearance.

5.Is it safe to use 40K on the entire body?

A: 40K can be applied on the entire body, but the head, back, and chest should be avoided. 40K treatment utilizes powerful sound wave vibrations for body sculpting. The chest is particularly sensitive to sound waves, and when vibrated, ultrasound can cause back-and-forth reflections, potentially leading to injuries. Additionally, ultrasound treatment should be strictly avoided around the eye area to prevent the risk of retinal detachment.

6.Are there any side effects of 40K on the human body?

A: 40K treatment is a non-surgical, non-invasive procedure that requires no incisions or anesthesia. It combines various technologies, including ultrasound (mechanical wave), cavitation, and ultrasound focusing. This procedure delivers multiple benefits such as breaking down adiposity, dissolving adiposity, tightening the skin, and sculpting the body. It selectively targets low-density adipose tissue

while safeguarding high-density tissues like blood vessels and nerves, ensuring no adverse effects on the body. You may notice a slight noise in your ears during the treatment, which is a normal occurrence and requires no cause for concern.

7.Why do I get tinnitus during the treatment?

A: When the ultrasound with concentrated energy vibrates strongly and has a frequency higher than 20KHz, it can penetrate the skin to reach the adipose layer that is 20mm deep. The energy causes high-speed friction and heat within the adipose tissue, which breaks them down and emulsifies them. However, this process can create noise that may be audible in your ears.

8.What is collagen?

A: Collagen is a biological polymer substance, a white opaque fibrous protein without branched chains, which can replenish essential nutrients needed by all layers of the skin and enhance the collagen activity in the skin, with the effects of locking moisture, moisturizing the skin, delaying aging, improving facial laxity and hair care. Collagen is an essential nutrient for promoting anti-aging effects. As you age, the gradual loss of collagen in your skin becomes evident. Typically, a woman's skin starts showing signs of aging around the age of 20 due to collagen depletion, and the rate of loss peaks at 25. Research suggests that by the age of 40, collagen levels are only about half of what they were at 18. The reduction in collagen and moisture content can contribute to the development of facial folds and wrinkles. This is primarily due to the breakdown of collagen fibers and elastic networks that support the skin. This loss also leads to oxidation, atrophy, and collapse of skin tissue, resulting in various signs of aging such as dehydration, wrinkles, looseness, and lack of elasticity.

9.Is laser treatment suitable for daily use?

A: No, daily use of laser treatment is not recommended. The body needs time for metabolism, and using the Lipo Laser pads every day may not speed up results. In fact, it could have adverse effects. The recommended frequency is 1-3 times a week. Combining it with other handles is also advisable for optimal results.

10.Are there any side effects associated with vacuum breast enlargement treatment?

A: No, there are no side effects at all. Vacuum breast enlargement therapy is entirely based on physical massage, suction, and release under negative pressure. With the integration of multiple advanced technologies, it provides users with immediate effects without any side effects or rebound effects.

9.Ask & Answer

Ask	Cause	Answer
1.Fail to turn on the instrument.	The power cord is disconnected from the outlet.	Check if the power cord is securely connected to the outlet and ensure that the outlet is functional.
	The fuse is loose or burned.	Replace the fuse on the back of the instrument and restart it.

Ask	Cause	Answer
2. The instrument is not working and can't be restarted.	The fuse may have burned out due to unstable voltage or prolonged use.	Please replace the fuse and restart the instrument 5 minutes later.
3.The screen shows an error message.	Data error.	1. Turn off the instrument, disconnect the power cord, and wait for 1 minute to restart the instrument. 2. If the above method doesn't resolve the problem, please contact your dealer.
4.The RF is not functioning.	The handle is not properly connected.	Please confirm if the handle plug is well connected to the main unit.
	Oil in the treatment area could result in insufficient contact between the handle and the body.	Apply some gels to the treatment area after cleaning.
	The handle is not in proper contact with the skin.	Ensure complete contact between the treatment head and the skin.

Ask	Cause	Answer
5.The 40K handle is not functioning.	→ You might mistakenly assume that the handle is not functioning properly because of its low-noise design.	→ To check if the handle is functioning, please refer to the 40K handle test.
	→ You may have forgotten to apply the gel or have used a product that is not designed for use with the instrument.	→ Please use the specific gel designed for the 40K treatment.
	→ Insufficient pressure.	→ Apply more pressure during the 40K handle application.
6.No suction or weak suction from the cup.	→ The hose is not securely attached.	→ Ensure the hose is tightly secured to the main machine.
	→ The cap on the inlet is loose or the rubber ring inside is broken or missed.	→ Secure the cap on the inlet tightly or replace the rubber ring inside.
	→ Check if you have set the knob.	→ Set the knob.

10.Operation Guide

Face:



Step 1: (10 minutes)

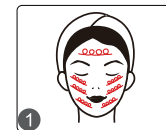

Step 2: (20 minutes)

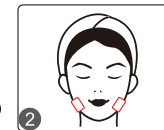

Eye:



Step 1: (10 minutes)



Arm:



Step 1: (15 minutes)



Step 2: (15 minutes)

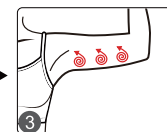
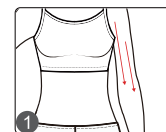

Step 3: (20 minutes)

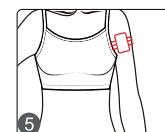

Belly:



Step 1: (15 minutes)



Step 2: (15 minutes)

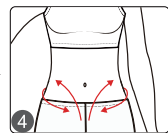
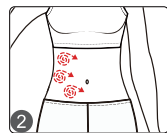
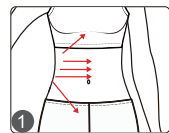

Step 3: (20 minutes)

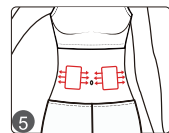

Back:



Step 1: (15 minutes)

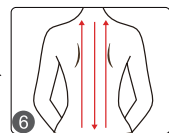
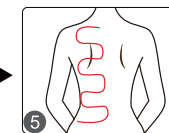
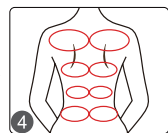
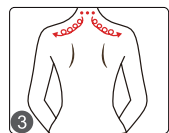
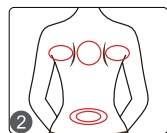
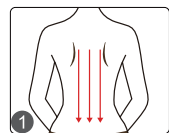

Leg:



Step 1: (15 minutes)



Step 2: (15 minutes)

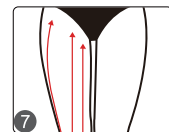
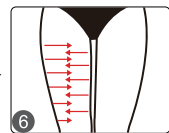
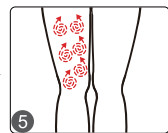
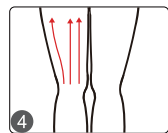
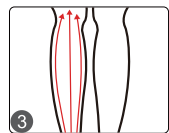
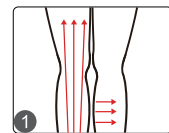

Step 3: (20 minutes)

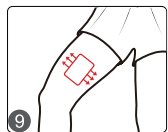

Breast enlargement:



Step 1: (20 minutes)

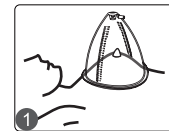

Butt augmentation:



Step 1: (15 minutes)

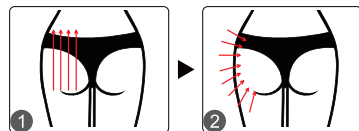

Step 2: (20 minutes)

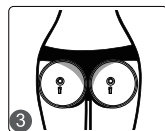

Face:



Step 1: (3 minutes)



Step 2: (10 minutes)



Step 3: (10 minutes)



Back:



Step 1: (15 minutes)

Step 2: (15 minutes)

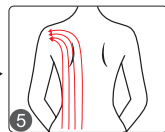
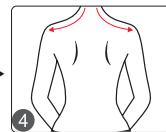
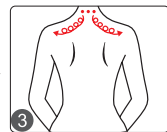
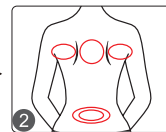
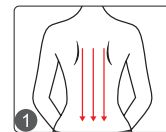
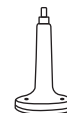

Leg:



Step 1: (15 minutes)

Step 2: (15 minutes)

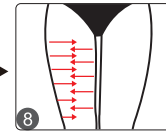
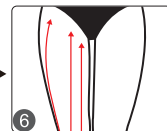
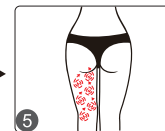
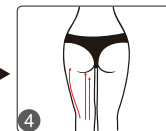
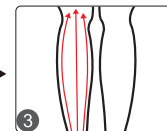
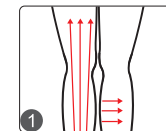
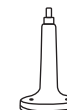

11.Warranty & Support

We provide a one-year warranty and a three-month return and replacement policy from the date of purchase.

Product Name: Versatile Beauty Enhancer
Product Model: DT-BS001N
Production Date: _____
Quality Inspection: _____

