

User Manual

SR-AF1323

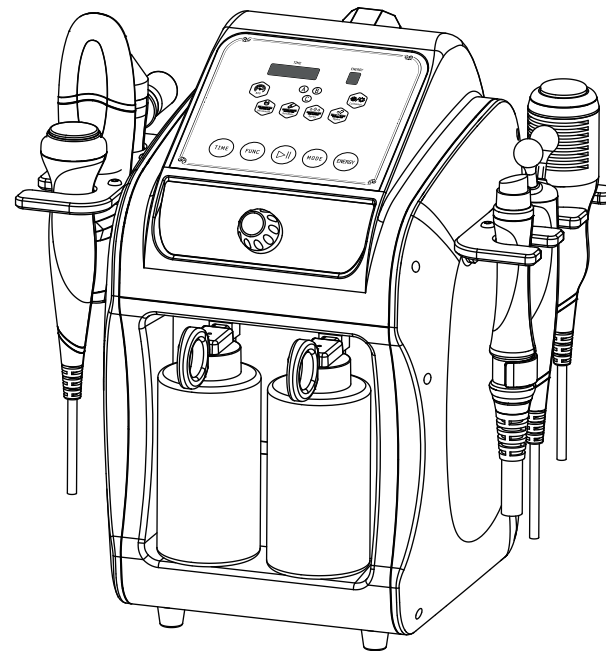

Content

1.Safety Precautions	1
2.Contraindications	2
3.Overview	2
4.Installation Instructions	3
5.Control Panel Introduction	10
6.Technical Specification	13
7.Use Precautions	14
8.Maintenance & Cleaning	14
9.FAQ	15
10.Troubleshooting	16
11.Operation Guide	18
12.Warranty & Support	21

1.Safety Precautions

- 1.Please read this manual carefully before use and familiarize yourself with the operation of this device and related technology.
- 2.As a high-precision electronic device, this device should be stored properly. Avoid humid conditions, direct sunlight, and proximity to flammable or explosive materials to prevent damage.
- 3.Always use the designated accessory provided or recommended by the manufacturer to ensure performance throughout its service life.
- 4.Do not place the device in high-temperature conditions, as this may negatively impact its service life and performance.
- 5.Do not apply the device on eyes, thyroid, parathyroid, testicles, pregnant women's abdomen, pace-makers, etc.
- 6.Patients should consult their doctor before using this device.
- 7.Ensure that the handle is applied on moist skin and avoid the operation on dry skin.
- 8.Power off the device when not in use to ensure its safety.
- 9.If you are currently taking anti-adiposity drugs, please discontinue their use for 1 - 2 months before using this device. Failure to do so may result in an extended course of treatment.
- 10.To maintain hygiene and extend the device's service life, sterilize it with saline.

2. Contraindications

Before using this device, it is essential to consult your doctor or seek advice from professionals. Details below:

1. Pregnancy or lactation.
2. Hypertension, heart disease, or with a pacemaker installed.
3. Unhealed wounds or ongoing recovery from recent surgery.
4. Sensitivity to micro-currents.
5. Epilepsy, severe diabetes, and hyperthyroidism.
6. Malignant tumors, hemophilia, and hemorrhage.
7. Skin disease or infectious disease.
8. Cesarean section within the last six months, a miscarriage within the last three months, or a natural birth within the last two months.
9. Recent plastic surgery (within three months), or presence of implants or metal objects in the treatment area.

3. Overview

This 6-in-1 beauty machine utilizes the most advanced technology for deep cleansing and complexion brightening, promising the user a glowing and vibrant face. It's the ideal solution for those looking to improve their skin without the need for injections, medications, or side effects. This non-invasive device delivers visible results with each use.

4. Installation Instructions

Packing List



Main unit * 1

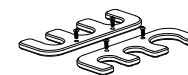

Handle Holders ×2

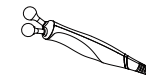

BIO Handle ×1



Ultrasound Handle ×1

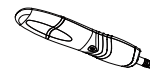

Scrubber Handle ×1



Hydro Handle ×1



Hydro Tips ×8



Cold & Hot Handle ×1



Oxygen Spray Handle ×1



Spray Solution Cup ×1



Filter ×1



Clean Bottles ×2



Waste Bottle ×1



Spray Cleaning Needle with Protective Tube ×1



Accessory Kit ×1 pack



Power cord ×1

1.Installing the Holders

Mount the holders onto the sides of the main unit.

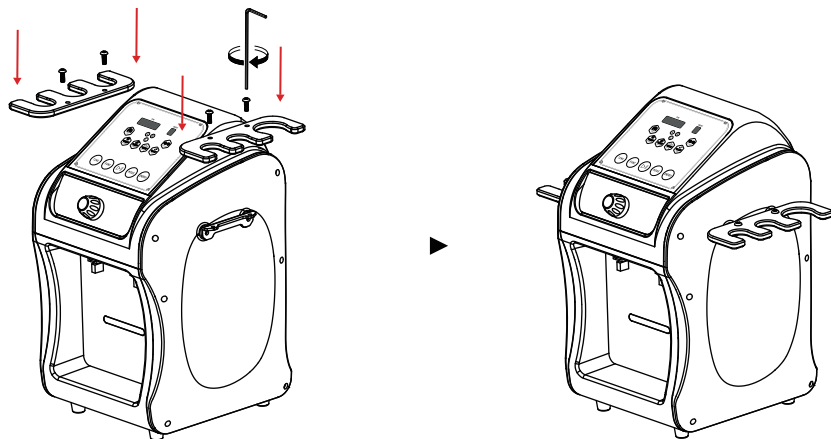

2.Installing the Filter

There are four small sealing rubber rings on the connection pins, and when unscrewing the filter, you will find another two larger rubber rings on the bottle neck. You can replace any of these rings with the spare ones provided in the accessory pack in case of damage.

To install the filter, make sure it is fully inserted into the socket on the main unit, leaving no gaps.

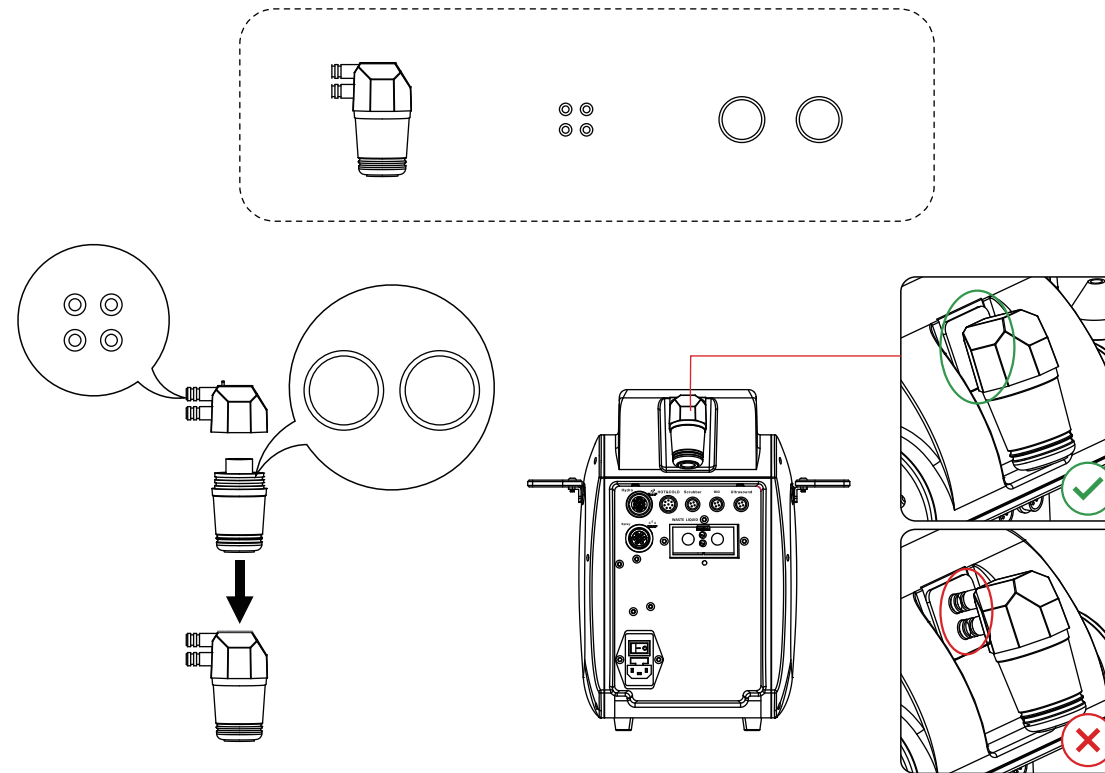

3.Handle Connection

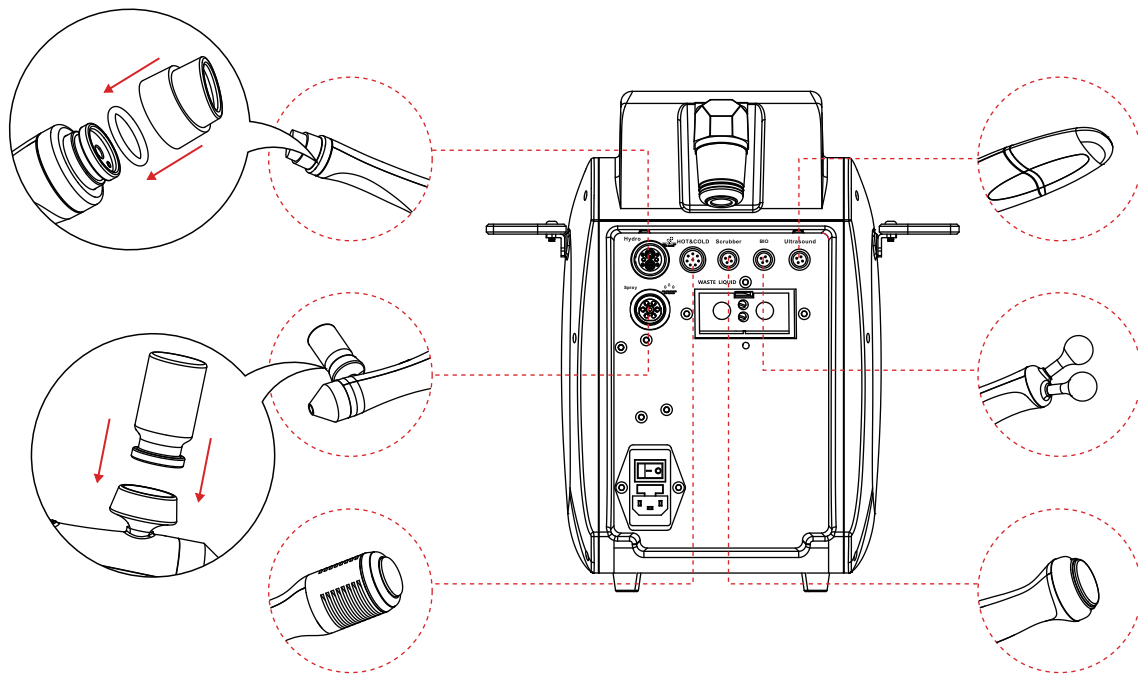

Handle Connection Caution

Hydro/Sprayer: Align the convex on the plug with the concave on the socket (as indicated by the arrows) to prevent weak suction or liquid leakage.

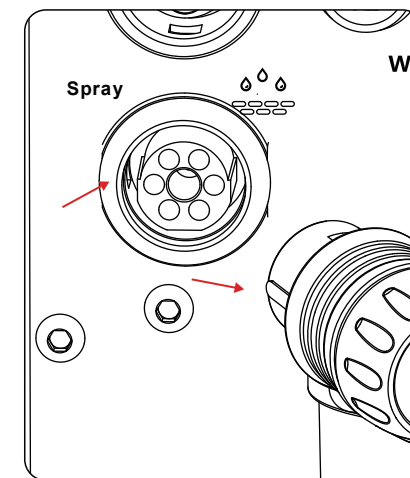
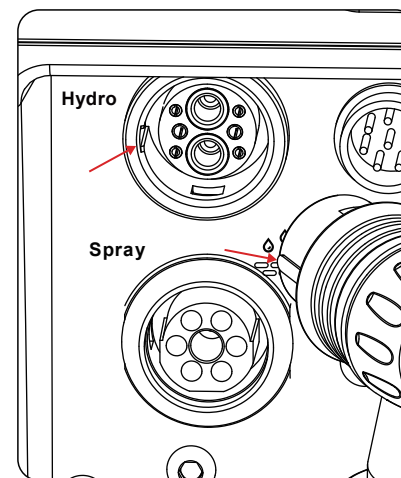

4.Installing the Clean Bottles

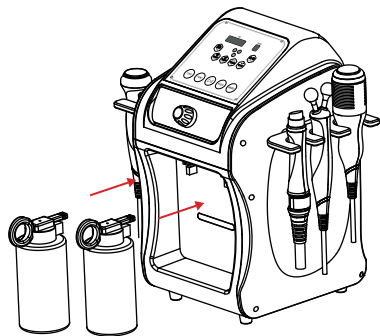

6.Congratulations!
You have completed all the steps

5.Installing the Waste Bottle

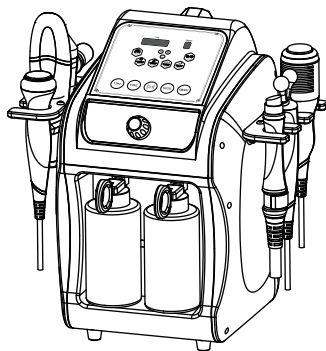
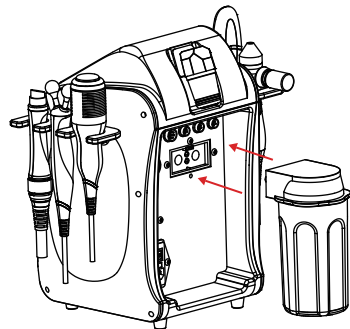

Replacing the Consumable Parts

Please replace the fuse at the back of the machine when the machine is short-circuited or cannot be started.

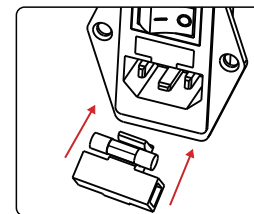
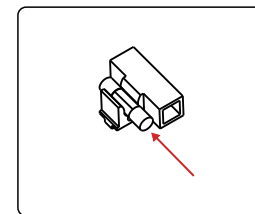
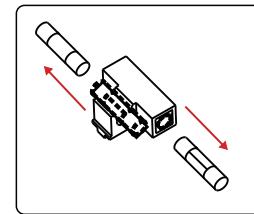
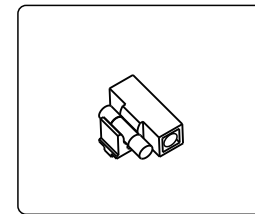
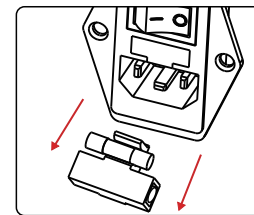
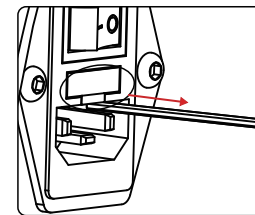
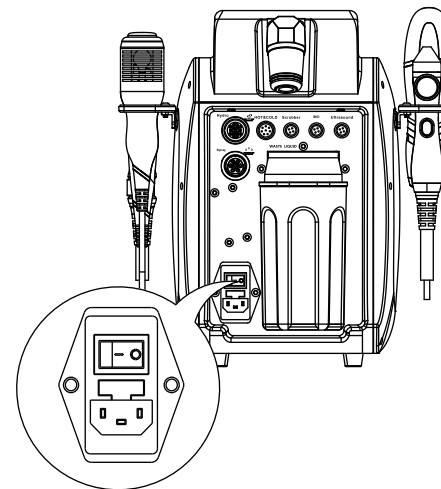

Replacing Rubber Rings for Hydro & Sprayer Handle

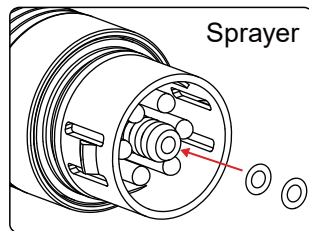
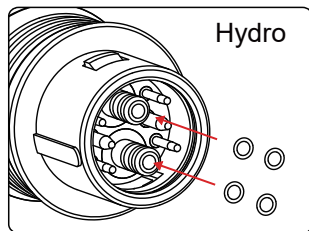



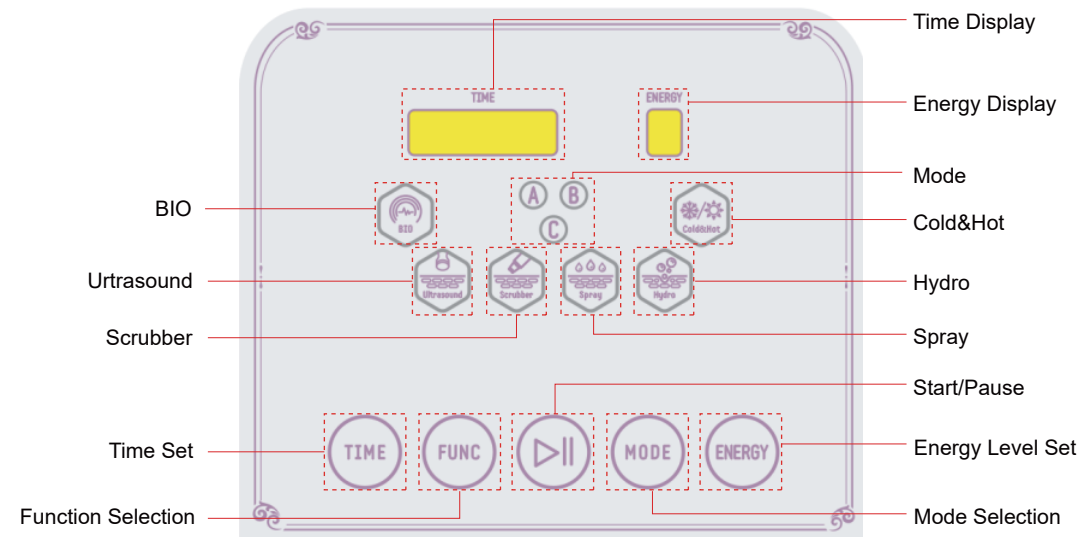
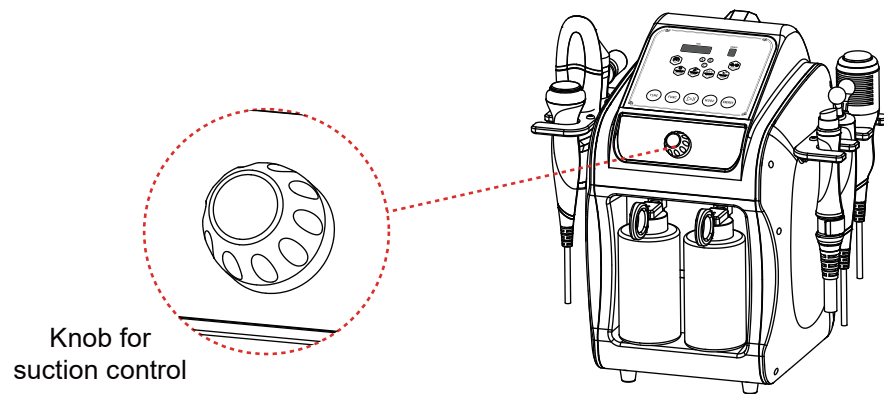

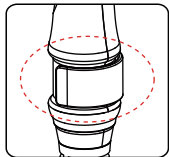
5.Control Panel Introduction









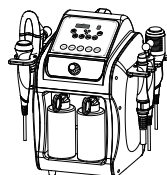

Control the water flow by rotating the Hydro handle tail - turn it to MIN to reduce the flow and to MAX to increase it.

Mode Setting					
A	Cleansing mode	Continuous working mode	Cold Hammer	Continuous working mode	A Bottle Selected
B	Infusion Mode	Fast Frequency	Hot Hammer	Intermittent working mode	B Bottle Selected
C	/	Slow Frequency	/	/	/

A/B Bottles for Hydro	
A	B
Exfoliation	Remove impurities and unclog pores

6. Technical Specification

	Power Supply Input: AC110V-240V 50Hz-60Hz		
	Power: 21W	Input Power: 21W	
	Gross Weight: 4.9KG	Net Weight: 5.7KG	
	Dimensions: 13.3×11.8×14.9inches		
	Frequency: 1MHz		Frequency: 24KHz
	Power: 12W		Power: 3W
	Power: Cold: 17W/Hot: 6W		Frequency: 62.5Hz
	COLD: 32-39.2°F HOT: 113°F		Power: 2W
	Power: 21W		
	Suction (KPa): 55Kpa		
	Vacuum flow rate L/min: 7L/min		
	Power: 11W		

7. Use Precautions

1. Strictly follow the instructions in the manual to use the device and train operator.
2. Before using the device, use a plug with a grounding pin and ensure the power socket is grounded.
3. Make sure the voltage of the device is adapted. If the local power supply voltage is unstable, we recommend adding a power-matched regulated power supply between the mains and the device.
4. Maintain the treatment head in full contact with the skin to avoid uneven heat.
5. Make sure the treatment area skin is moist, do not operate on dry skin.
6. Do not touch the air outlet during the Hot & Cold hammer session to avoid burn.

8. Maintenance & Cleaning

1. Disconnect the power cord when not in use and store the device in a dry, cool, and well-ventilated place.
2. **Hydro Tip Cleaning:** After use, rinse the tip in saline, brush it clean, air dry, and store in a dry place.
3. **Hydro Handle Cleaning:** Fill the clean bottle with water, adjust settings, activate the Hydro treatment, cover the tip with your thumb, then remove it. Repeat for 2 minutes.
4. **Spray Handle Cleaning:** Fill the solution cup with pure water, then spray all the water out.
5. Clean and sanitize the handle with a damp cloth or saline, and then dry it thoroughly with a dry towel to ensure it remains dry.
6. After cleaning the device, cover it with a dustcloth or plastic wrap. Before use, ensure to sanitize the handle again for hygienic reasons.

7. Disassembling the device and attempting to clean the inside is strictly prohibited. This task should only be performed by professionals.

9. FAQ

1. Will the skin get thinner and more sensitive after the Hydro treatment?

A: No, Hydro treatment exclusively targets clogged pores, enhancing nutrient absorption for smoother, finer, and more translucent skin without causing sensitivity.

2. Why do I need exfoliation?

A: The stratum corneum, the outermost layer of the epidermis, consists of 15–20 layers of skin components that vary by body area. The skin's renewal cycle also changes with age—typically 28 days for teenagers and an individual's age plus 10 days for adults. However, various factors can disrupt this process, causing the stratum corneum to accumulate, leading to a dull complexion and sluggish skin metabolism. In such cases, exfoliation is essential to promote healthy skin renewal.

3. Can I apply makeup immediately after using this device?

A: Yes, the treatment enhances skin hydration and plumpness, ensuring smooth and well-blended makeup application. This non-invasive approach delivers fast, safe, and healthy results.

4. When can I expect to see results?

A: You will notice improved skin clarity and radiance immediately after the first session. Multiple treatments enhance hydration, brighten the complexion, reduce fine lines, and help slow the aging process.

10.Troubleshooting

Ask	Possible Cause & Solution
The Hydro Handle is not Functioning.	<p>1. No suction from the Hydro Handle. Possible Causes: (1) The water pump is not working (when functioning, the device sound changes, and slight water vibration is visible in the waste bottle). (2) The Hydro suction knob on the main unit is not set properly. (3) The filter is missing, or its rubber rings are damaged. (4) Improper filter installation. (5) Poor connection between the handle and main unit. (6) The rubber ring on the tip end of the handle is broken or missing. (7) The waste bottle is not installed properly. Solutions: (1) Replace the main unit. (2) Turn the Hydro suction knob toward MAX. (3) Install the filter or replace the rubbers on it. (4) Ensure the filter is installed correctly. (5) Secure the handle plug firmly into the main unit, ensuring no gaps. (6) Replace the rubber ring on the tip end of the handle. (7) Properly install the waste bottle.</p>

Ask	Possible Cause & Solution
The Hydro Handle is not Functioning.	<p>2. No Water Coming from the Hydro Handle Possible Causes: (1) The clean bottle is empty. (2) The tube inside the bottle is not fully submerged in the solution. (3) The Hydro water flow is not set properly. (4) The rubber ring on the clean bottle is damaged or missing. Solutions: (1) Refill the fresh bottle with solution. (2) Ensure the tube end is fully submerged in the solution. (3) Turn the Hydro handle knob toward MAX. (4) Install or replace the rubber ring on the clean bottle.</p>
The Spray Handle is not Functioning.	<p>1. Spray Handle Not Responding Possible Causes: (1) The Spray handle switch is not activated. (2) The air pump is not working (the device sound changes when functioning). (3) The solution is too thick to be sprayed. (4) Poor connection between the Spray handle and main unit. Solutions: (1) Activate the Spray handle switch. (2) Replace the main unit if the pump is not working. (3) Dilute the solution to a 1:10 serum-to-saline ratio. If the issue persists, unclog the Spray nozzle with a needle. (4) Secure the handle plug with the main unit, ensuring no gaps.</p>

11.Operation Guide

Face

Preparation: Wash basin, disposable bag, makeup remover, facial cleanser, washcloth, cuticle softener, toner, cotton pads, facial mask, gel, essence, lotion, cream, and SPF.

1.Remove makeup and cleanse the skin.

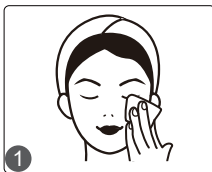

2.Apply toner to the skin.



3.Apply cuticle softener evenly to the forehead, nose, chin, and cheeks.

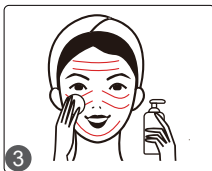

4.Settings:

4.1Tap "FUNC" and select "Hydro".

Time: 3 minutes

Bottle: Bottle A

Water Flow: Moderate

Suction: Adjust according to individual endurance.

Treatment aids: Wet cotton pad

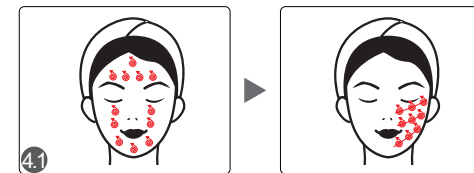

4.2Tap "FUNC" and select "Scrubber".

Time: 2 minutes

Energy Level: 3

Mode: A

Treatment aids: Wet cotton pad



4.3Tap "FUNC" and select "Spray".

Time: 10 minutes

Supplies: Serum + Saline Solution (1: 10)



4.4Tap "FUNC" and select "Hot&Cold".

Time: 5 minutes

Energy Level: 3

Mode: Cold

Supplies: Essence



4.5 Tap "FUNC" and select "Ultrasound".

Time: 5 minutes

Energy Level: 3

Mode: A

Supplies: Gel



4.6 Tap "FUNC" and select "BIO".

Time: 5 minutes

Energy Level: 3

Mode: A

Supplies: Essence



5. Apply a facial mask for 15 minutes.



6. Remove the mask and proceed with your daily skincare routine after cleansing.



12. Warranty & Support

We offer a one-year warranty on the main unit and a three-month warranty on components.

Product Name: HydraClean Device

Product Model: SR-AF1323

Production Date: _____

Quality Inspection: _____

