

User Manual

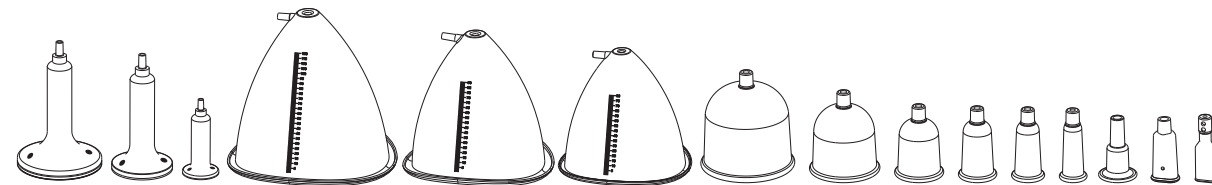
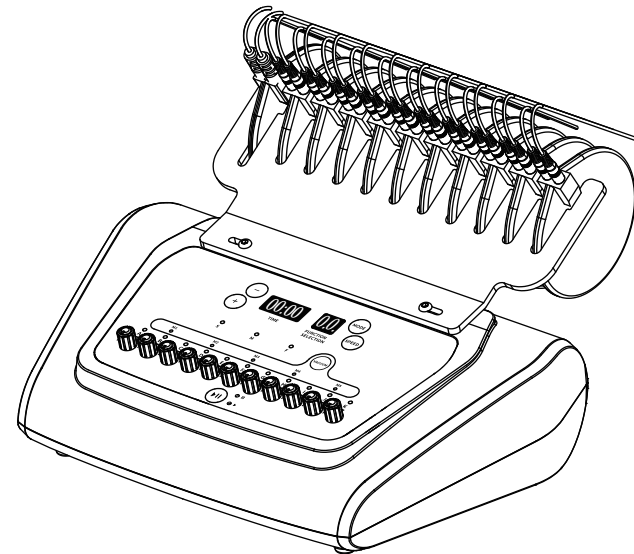

Content

1.Safety Precautions	1
2.Contraindications	2
3.Overview	2
4.Control Panel Introduction	3
5.Technical Specification	7
6.Use Precautions	8
7.Maintenance & Cleaning	8
8.FAQ	9
9.Troubleshooting	11
10.Operation Guide	12
11.Warranty & Support	15

1.Safety Precautions

- 1.Please read this manual carefully before use and familiarize yourself with the operation of this device and related technology.
- 2.As a high-precision electronic device, this device should be stored properly. Avoid humid conditions, direct sunlight, and proximity to flammable or explosive materials to prevent damage.
- 3.Always use the designated accessory provided or recommended by the manufacturer to ensure performance throughout its service life.
- 4.Do not place the device in high-temperature conditions, as this may negatively impact its service life and performance.
- 5.Do not apply the device on eyes, thyroid, parathyroid, testicles, pregnant women's abdomen, pace-makers, etc.
- 6.Patients should consult their doctor before using this device.
- 7.Power off the device when not in use to ensure its safety.
- 8.If you are currently taking anti-adiposity drugs, please discontinue their use for 1 - 2 months before using this device. Failure to do so may result in an extended course of treatment.
- 9.To maintain hygiene and extend the device's service life, sterilize it with saline.

2. Contraindications

Before using this device, it is essential to consult your doctor or seek advice from professionals. Details below:

1. Pregnancy or lactation.
2. Hypertension, heart disease, or with a pacemaker installed.
3. Unhealed wounds or ongoing recovery from recent surgery.
4. Individuals who are sensitive to the micro-current.
5. Epilepsy, severe diabetes, and hyperthyroidism.
6. Malignant tumors, hemophilia, and hemorrhage.
7. Skin disease or infectious disease.
8. Cesarean section within the last six months, a miscarriage within the last three months, or a natural birth within the last two months.
9. Recent plastic surgery (within three months), or presence of implants or metal objects in the treatment area.

3. Overview

Featuring advanced, safe technology for skin firming and body contouring, this 2-in-1 beauty device helps you achieve a sculpted figure and a radiant complexion. It provides an ideal solution for those seeking skin and body improvements without injections, drugs, or side effects. This non-invasive device delivers visible results with each use.

4. Control Panel Introduction

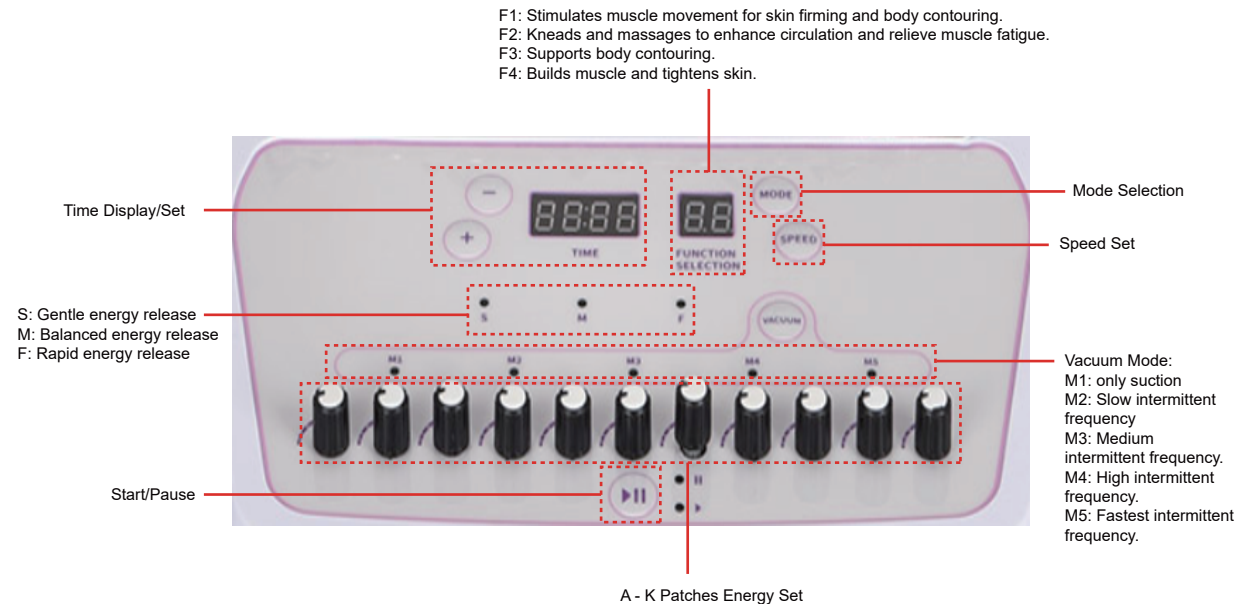

Hose Connections

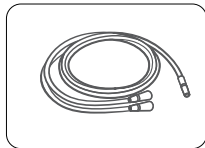

Connect the wide Y-shaped hose for the vacuum cup.

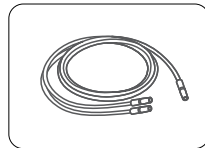

Connect the narrow Y-shaped hose for the breast cup.

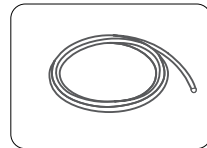

the straight hose is designed for roller cup use.

Hose Connection Instructions

- Wide/Narrow Y-Shaped Hose:
 - Connect one end to the inlet on the main unit.
 - Attach the two remaining ends to the two vacuum or breast cups.
 - For single-cup use: Tie a knot on the spare end. Untie if switching to two-cup use.
- Straight Hose:
 - Connect one end to the inlet on the main unit.
 - Attach the other end to the roller cup.

How to choose the breast cup/vacuum cup/roller cup

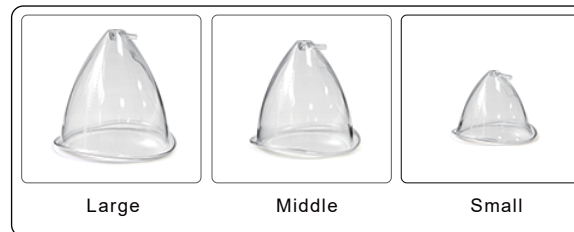

Breast cup, choose according to the size of the breast or buttocks.



Vacuum cup

Cup No. 1 is used for cupping therapy, moving cupping therapy (for large body area, e.g., thighs, buttocks, abdomen)

Cup No. 2 is used for cupping therapy, moving cupping therapy (for body areas like legs, back)

Cup No. 3 is used for cupping therapy, moving cupping therapy (for small body area, e.g., arms, lower legs)

Cup No. 4 is used for moving cupping therapy (for body areas like neck, arms)

Cup No. 5 is used for moving cupping therapy, massage (for body areas like face, neck)

Cup No. 6 is used for moving cupping therapy, cleansing (for face area)

Cup No. 7 is used for secret area.

Cup No. 8 is used for facial cleansing.



Cup No. 9 is used for cleansing or moving cupping therapy.



Roller Cup

- ❶ The large cup is used for large body areas, such as arms, abdomen, abdomen, waist, buttocks, legs, and back.
- ❷ The medium cup is used for the face or parts of the body area, such as arms, neck, face, and lower legs.
- ❸ The small cup is used for the facial area, such as cheeks, around the eyes, forehead, chin, and neck.

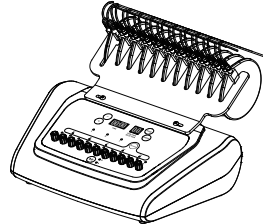
5. Technical Specification

	Power supply Input: AC110V-240V 50Hz-60Hz	
	Input Power: 20.7W	
	Dimensions: 12.2 × 13 × 7.5 inches	
	Net Weight: 4.5KG	Gross Weight: 5.5KG
	Power: 11.6W	Airflow (l/min): 8LPM
	Suction intensity: -70KPa	Noise level (30cm away): 65dB
	Frequency: 250Hz	
	Power: 16.5W	

6. Use Precautions

1. Strictly follow the instructions in the manual to use the device and train operator.
2. Before using the device, use a plug with a grounding pin and ensure the power socket is grounded.
3. Make sure the voltage of the device is adapted. If the local power supply voltage is unstable, we recommend adding a power-matched regulated power supply between the mains and the device.
4. Remove all the metal objects inside the body to avoid causing accidents or affecting treatment effects.
5. Refrain from using the device on an empty stomach, and initiate the treatment one hour after a meal.
6. Always start with the lowest suction intensity.
7. Before treatment, inform the recipient about microcurrent sensations to prevent concerns or discomfort.

7. Maintenance & Cleaning

1. Disconnect the power cord when not in use and store the device in a dry, cool, and well-ventilated place.
2. Clean and sanitize the device with a damp cloth or saline, and then dry it thoroughly with a dry towel to ensure it remains dry.
3. To clean the vacuum cup and roller cup, wipe them with a wet wipe or saline to clean and sterilize, then dry them with a dry towel.
4. After cleaning the device, cover it with a dustcloth or plastic wrap. Before use, ensure to sanitize the handle again for hygienic reasons.

5. Disassembling the device and attempting to clean the inside is strictly prohibited. This task should only be performed by professionals.

8. FAQ

1. Any pain during the EMS treatment?

A: No, there isn't. The EMS treatment utilizes microcurrent to stimulate the body, providing a comfortable and enjoyable experience similar to traditional massage techniques.

2. What are the features of this device?

A: When applied to the body, this treatment effectively sculpts localized areas, boosts metabolism, promotes whole-body detoxification, and enhances internal organ function, all while addressing sub-health concerns.

3. Do I need to keep on a healthy diet during the treatment period?

A: It would be better if you could keep on a healthy diet, since after the Ultrasonic treatment, the metabolism will be accelerated, and eating spicy, greasy, and fried food will affect the metabolism. Moderate exercise and sweating can help the body excrete metabolic waste, and the weight loss effect will be more obvious.

4.Are there any side effects associated with vacuum breast enlargement treatment?

A: No, there are no side effects at all. Vacuum breast enlargement therapy is entirely based on physical massage, suction, and release under negative pressure. With the integration of multiple advanced technologies, it provides users with immediate effects without any side effects or rebound effects.

5.When will I see results from a facial treatment with the vacuum cup?

A: After treatment, you'll notice purified pores and smoother skin instantly. We recommend a weekly treatment for best results, with increasing improvements day by day.

6.How does negative pressure help in detoxification?

A: Negative pressure can stimulate capillary congestion and boost cellular vitality. The alternation of negative pressure promotes the opening and closing of pores in the targeted area, improving skin breathing, increasing oxygen uptake, and aiding in the elimination of wastes. In summary, this treatment promotes Qi and circulation, dispels dampness and cold, clears meridians, detoxifies, and purges heat.

9.Troubleshooting

Ask		Cause		Answer
1.Fail to turn on the device.	→	The power cord is disconnected from the outlet.	→	Check if the power cord is securely connected to the outlet and ensure that the outlet is functional.
2.No electric current sensation during treatment.	→	Check the connection port where the cable connects the host and the handle. The cable may be loose.	→	To check if the handle is functioning, please refer to the 40K handle test.
	→	You may have applied the wrong patches.	→	Verify if the EMS patches you applied match those you selected on the control panel.
	→	The application of gel to the patch has been omitted.	→	Apply gel to the patch.
3.Weak or no suction from the vacuum cup/roller cup.	→	The hose is not securely attached.	→	Ensure the hose is tightly secured to the main unit.
	→	The cap on the inlet is loose or the rubber ring inside is broken or missed.	→	Secure the cap on the inlet tightly or replace the rubber ring inside.
	→	Check if you have set the knob.	→	Set the knob.

10.Operation Guide

Breast enlargement:



Step 1: (20 minutes)

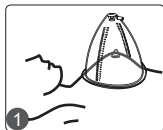

> Step 2: (EMS patch 20 minutes)



Butt augmentation:



Step 1: (15 minutes)

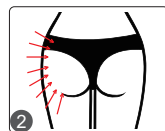
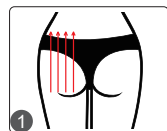

> Step 2: (20 minutes)

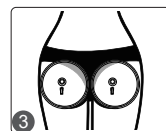

Face:



Step 1: (3 minutes)

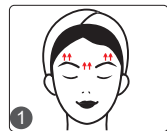

>Step 2: (10 minutes)> Step 3: (10 minutes)



Arm:



Step 1: (15 minutes) > Step 2: (15 minutes)

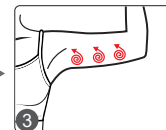

> Step 3: (EMS patch 20 minutes)

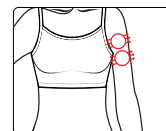

Back:



Step 1: (15 minutes) > Step 2: (15 minutes)

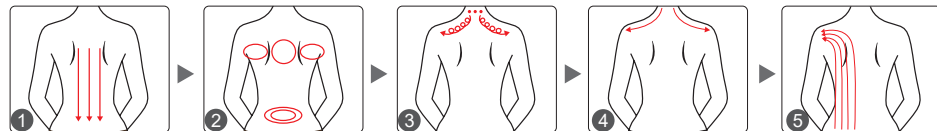

Leg:



Step 1: (15 minutes) > Step 2: (15 minutes)

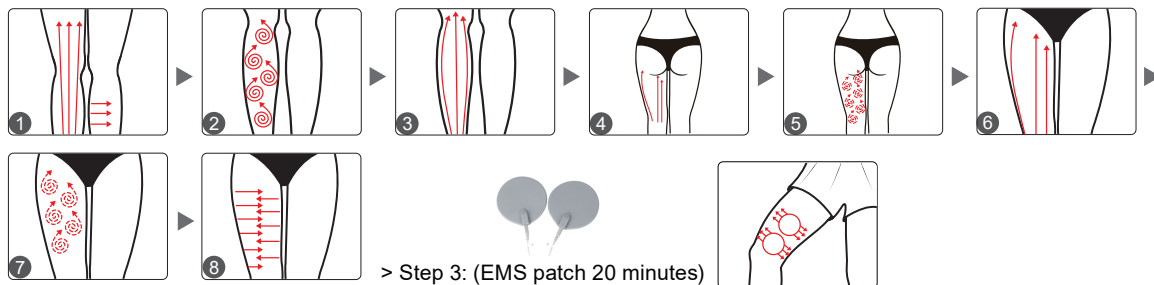

> Step 3: (EMS patch 20 minutes)

Belly:

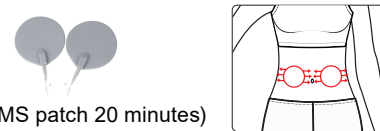

Step 1: (EMS patch 20 minutes)

11. Warranty & Support

We offer a one-year warranty on the main unit and a three-month warranty on components.

Product Name: Versatile Beauty Enhancer
 Product Model: MS-33J4U
 Production Date: _____
 Quality Inspection: _____

PASS