

User Manual

MS-2175

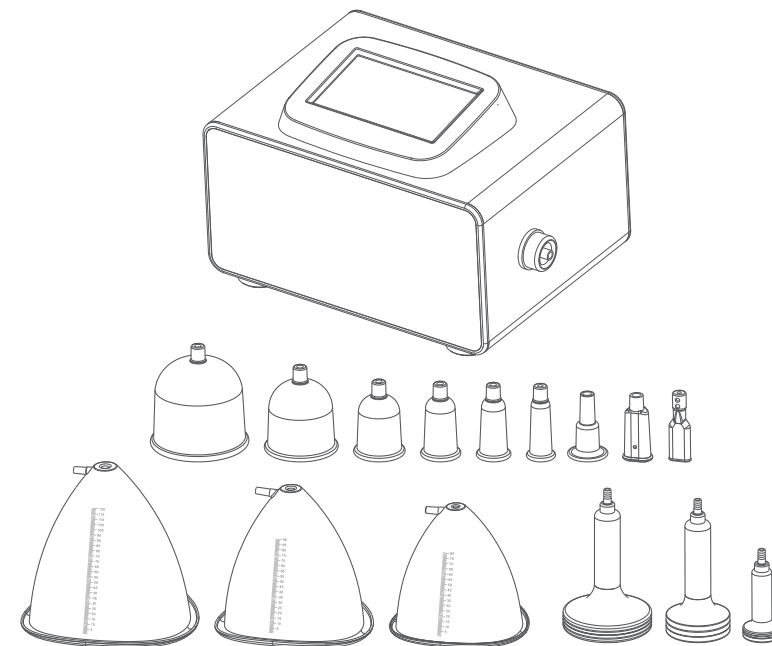

Content

1.Safety Precautions	1
2.Contraindications	2
3.Overview	2
4.Control Panel Introduction	3
5.Technical Specification	8
6.Use Precautions	8
7.Maintenance & Cleaning	9
8.FAQ	9
9.Troubleshooting	10
10.Operation Guide	11
11.Warranty and Support	14

1.Safety precautions

- 1.Please read this manual carefully before use and familiarize yourself with the operation of this device and related technology.
- 2.As a high-precision electronic device, this device should be stored properly. Avoid humid conditions, direct sunlight, and proximity to flammable or explosive materials to prevent damage.
- 3.Always use the designated accessory provided or recommended by the manufacturer to ensure performance throughout its service life.
- 4.Do not place the device in high-temperature conditions, as this may negatively impact its service life and performance.
- 5.Do not apply the device on eyes, thyroid, parathyroid, testicles, pregnant women's abdomen, pacemakers, etc.
- 6.Patients should consult their doctor before using this device.
- 7.Ensure that the device is applied on moist skin and avoid the operation on dry skin.
- 8.Power off the device when not in use to ensure its safety.
- 9.If you are currently taking anti-adiposity drugs, please discontinue their use for 1 - 2 months before using this device. Failure to do so may result in an extended course of treatment.
- 10.To maintain hygiene and extend the device's service life, sterilize it with saline.

2. Contraindications

Before using this device, it is essential to consult your doctor or seek advice from professionals. Details below:

1. Pregnancy or lactation.
2. Heart conditions, including the presence of a pacemaker.
3. Unhealed wounds or ongoing recovery from recent surgery.
4. Epilepsy, severe diabetes, and hyperthyroidism.
5. Malignant tumors, hemophilia, and hemorrhage.
6. Skin disease or infectious disease.
7. Cesarean section within the last six months, a miscarriage within the last three months, or a natural birth within the last two months.
8. Recent plastic surgery (within three months), or presence of implants or metal objects in the treatment area.

3. Overview

With the most popular and safest technology, this vacuum beauty device ensures you achieve your desired body figure. It provides an ideal solution for those seeking skin and body improvements without injections, drugs, or side effects. Expect immediate results with its external application.

4. Control Panel Introduction

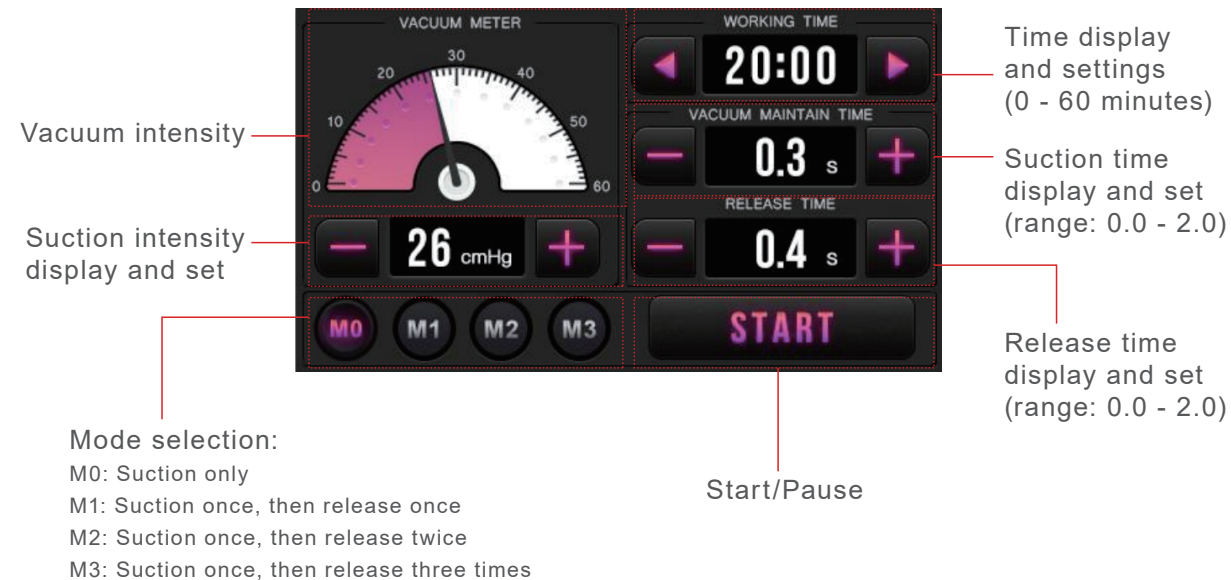

Cotton Filter Replacement



Open the inlet by twisting off the cap, insert a cotton filter, and then reattach and secure the cap by twisting it clockwise.

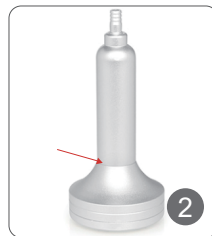

Unscrew the component marked with the arrow, replace the filter, and then securely reattach the disassembled part.

Hose Connections

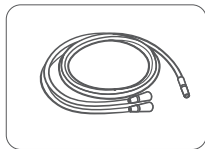

Connect the wide Y-shaped hose for the vacuum cup.

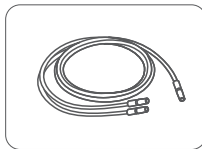

Connect the narrow Y-shaped hose for the breast cup

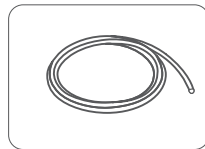

The straight hose designed for grease cup use.

Hose Connection Instructions

- Wide/Narrow Y-Shaped Hose:
 - Connect one end to the inlet on the main unit and attach the other two ends to the vacuum or breast cups. Ensure both cups make simultaneous contact with the skin to generate suction.
 - For single-cup use: Tie a knot on the spare end. Untie if switching to two-cup use.
- Straight Hose:
 - Connect one end to the inlet on the main unit.
 - Attach the other end to the roller cup.

How to choose the breast cup/vacuum cup/grease cup

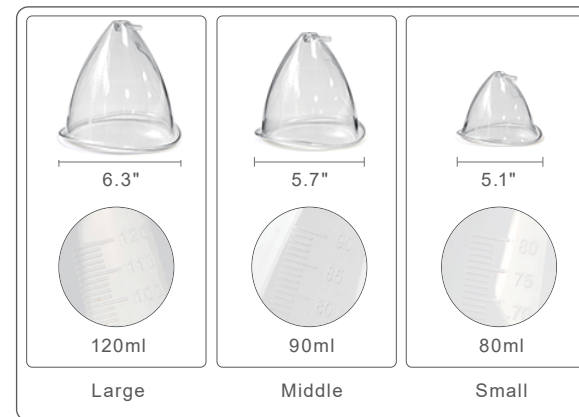

Breast cup, choose according to the size of breast or buttocks.



9 pairs of vacuum cup

Cup No. 1 is used for cupping therapy, moving cupping therapy (for large body area, e.g., thighs, buttocks, abdomen)

Cup No. 2 is used for cupping therapy, moving cupping therapy (for body areas like legs, back)

Cup No. 3 is used for cupping therapy, moving cupping therapy (for small body areas, e.g., arms, lower legs)

Cup No. 4 is used for moving cupping therapy (for body areas like neck, arms)

Cup No. 5 is used for moving cupping therapy, massage (for body areas like face, neck)

Cup No. 6 is used for moving cupping therapy, cleansing (for face area)

Cup No. 7 is used for secret area.

Cup No. 8 is used for facial cleansing.

Cup No. 9 is used for moving cupping therapy, cleansing.

Roller Cup

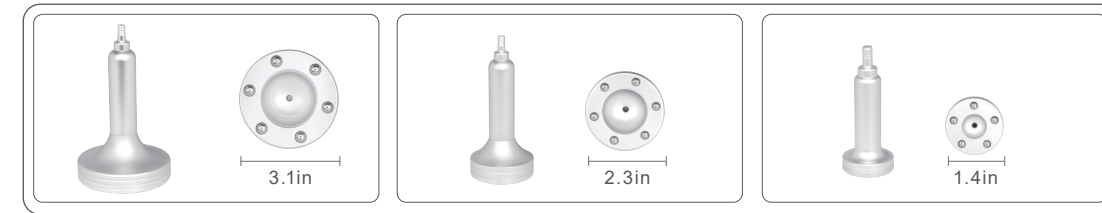

- 1 The large cup is used for large body areas, such as arms, abdomen, waist, buttocks, legs, and back.





- 2 The medium cup is used for the face or parts of the body area, such as arms, neck, face, and lower legs.

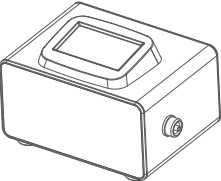

- 3 The small cup is used for the facial area, such as cheeks, around the eyes, forehead, chin, and neck.

5. Technical Specifications

	Power supply Input: AC110v-220v 50Hz/60Hz	
	Power:15W	Input Power:15W
	Dimensions: 9.7"×6.6"×5.9"	
	Net Weight: 4.2kg	Gross Weight: 5.0kg
	Power:15W	Air flow: 10LPM
	Vacuum Suction: -60KPa	Noise level: <65db (30cm away)

6. Use Precautions

1. Strictly follow the instructions in the manual to use the device and train operator.
2. Before using the device, use a plug with a grounding pin and ensure the power socket is grounded.
3. Make sure the voltage of the device is adapted. If the local power supply voltage is unstable, we recommend adding a power-matched regulated power supply between the mains and the device.

4. Remove all the metal objects inside the body to avoid causing accidents or affecting treatment effects.

5. Refrain from using the device on an empty stomach, and initiate the treatment one hour after a meal.

6. Always start with the lowest suction intensity.

7. Maintenance & Cleaning

1. Disconnect the power cord when not in use and store the device in a dry, cool, and well-ventilated place.

2. To clean the vacuum cup and roller cup, wipe them with a wet wipe or saline to clean and sterilize, then dry them with a dry towel.

3. After cleaning the device, cover it with a dustcloth or plastic wrap. Before use, ensure to sanitize the handle again for hygienic reasons.

4. Disassembling the device and attempting to clean the inside is strictly prohibited. This task should only be performed by professionals.

8. FAQ

1. Are there any side effects associated with vacuum breast enlargement treatment?

A: No, there are no side effects at all. Vacuum breast enlargement therapy is entirely based on physical massage, suction, and release under negative pressure. With the integration of multiple advanced technologies, it provides users with immediate effects without any side effects or rebound effects.

2. When do I expect to see the result of facial treatment with the vacuum cup?

A: After treatment, you'll notice purified pores and smoother skin instantly. We recommend a weekly treatment for best results, with increasing improvements day by day.

3. How does negative pressure aid in detoxification during treatment?

A: Negative pressure can stimulate capillary congestion and boost cellular vitality. The alternation of negative pressure promotes the opening and closing of pores in the targeted area, improving skin breathing, increasing oxygen uptake, and aiding in the elimination of wastes. In summary, this treatment promotes Qi and circulation, dispels dampness and cold, clears meridians, detoxifies, and purges heat.

9. Troubleshooting

Ask	Cause	Answer
1. Fail to turn on the device.	→ The power cord is disconnected from the outlet.	→ Check if the power cord is securely connected to the outlet and ensure that the outlet is functional.
	→ The fuse is loose or burned.	→ Replace the fuse on the back of the device and restart it.

Ask	Cause	Answer
2. Weak or no suction from the vacuum cup/massage roller.	→ The hose is not securely attached.	→ Ensure the hose is tightly secured to the main unit.
	→ The cap on the inlet is loose or the rubber ring inside is broken or missed.	→ Secure the cap on the inlet tightly or replace the rubber ring inside.
	→ Check if you have set the knob.	→ Set the knob.

10. Operation Guide

Breast enlargement:



(20 minutes)

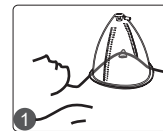

Butt augmentation:

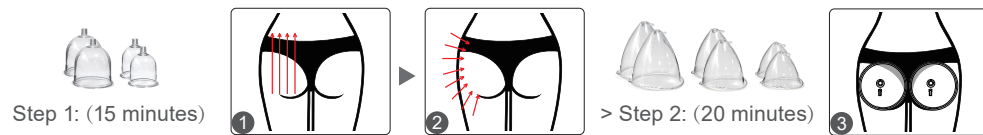

Face:

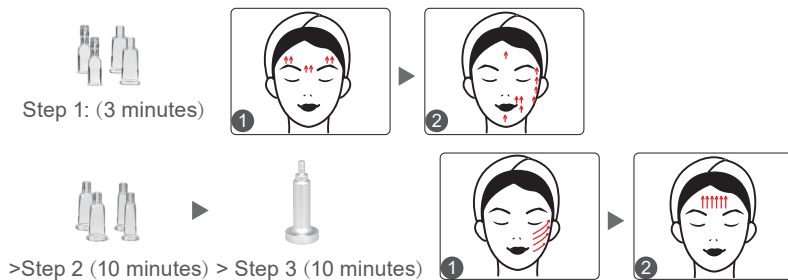

Arm:

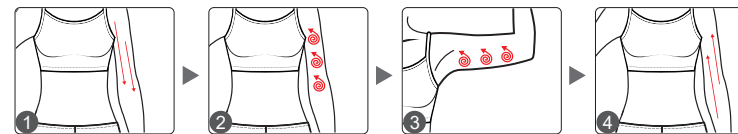

Back:

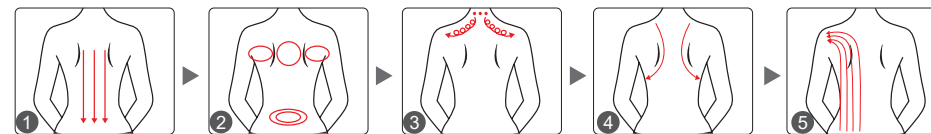
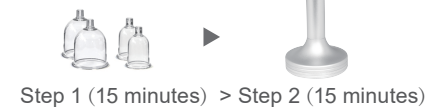

Leg:

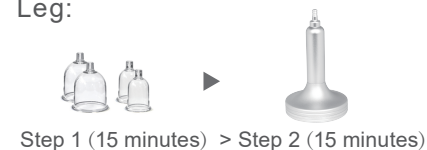

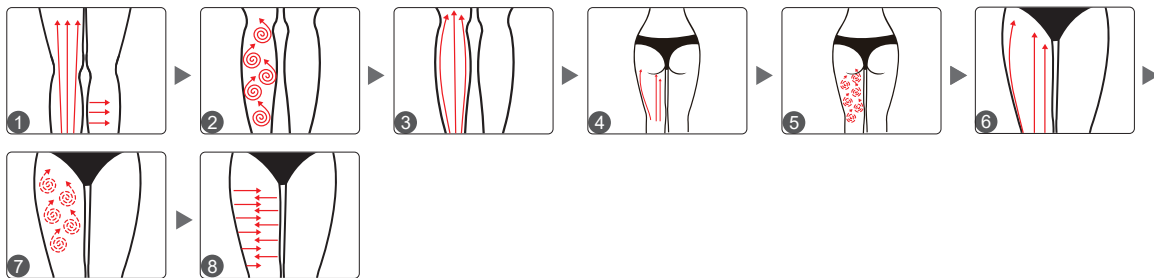

11.Warranty and Support

We offer a one-year warranty on the main unit and a three-month warranty on components.

Product Name: Vacuum Sculptor _____
Product Model: MS-2175 _____
Production Date: _____
Quality Inspection: _____

PASS