

# User Manual

BS-32K1

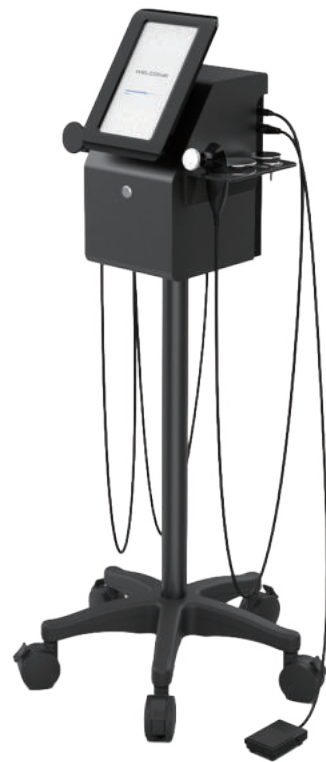

## Content

1.Safety Precautions .....	1
2.Contraindications .....	1
3.Overview .....	2
4.Interface Function .....	3
5.Technical Specification .....	6
6.Use Precautions .....	7
7.Maintenance & Cleaning .....	7
8.FAQ .....	8
9.Ask & Answer .....	9
10.Operation Guide .....	11
11.Warranty and support .....	14

## 1.Safety Precautions

- 1.Please read this manual carefully before use and familiarize yourself with the operation of this instrument and related technology.
- 2.This instrument is a high-precision electronic device that requires proper storage. Please avoid storing it in humid conditions, direct sunlight, or near flammables and explosives to prevent damage.
- 3.Always use the designated accessory provided or recommended by the manufacturer to ensure performance throughout its service life.
- 4.Do not place the instrument in high-temperature conditions, as this may negatively impact its service life and performance.
- 5.Do not apply the instrument on eyes, thyroid, parathyroid, testicles, pregnant women's abdomen, pacemakers, etc.
- 6.Patients should refrain from using this instrument unless they have obtained permission from their doctor.
- 7.Ensure that the instrument is applied on moist skin and avoid the operation on dry skin.
- 8.Power off the instrument when not in use to ensure its safety.
- 9.If you are currently taking anti-adiposity drugs, please discontinue their use for 1 - 2 months before using this instrument. Failure to do so may result in an extended course of treatment.
- 10.To maintain hygiene and extend the instrument's service life, sterilize it with saline.

## 2.Contraindications

Before using this instrument, it is essential to consult your doctor or seek advice from professionals. Details below:

1. Pregnant or lactating woman.
2. Individuals with hypertension, heart disease, or a pacemaker installed.
3. Individuals with unhealed wounds or those in the recovery period from surgery.
4. Individuals suffering from epilepsy, severe diabetes, and hyperthyroidism.
5. Individuals suffering from malignant tumors, hemophilia, and hemorrhage.
6. Individuals with skin disease or infectious disease.
7. Individuals who have had a cesarean section within the last six months, a miscarriage within the last three months, or a natural birth within the last two months should refrain from using this instrument.
8. For your safety, refrain from using if you've had plastic surgery or have implants/metal objects near the treatment area within 3 months.

### 3. Overview

This dual-function beauty machine features the most popular and safe anti-aging, tightening and shaping technologies, helping you achieve changes on your face and body. It solves the problems of skin and body management for those who love beauty. This device does not require injections or medications, and has no side effects. It is used externally throughout the process and has a gradual improvement effect.

### 4. Interface Function

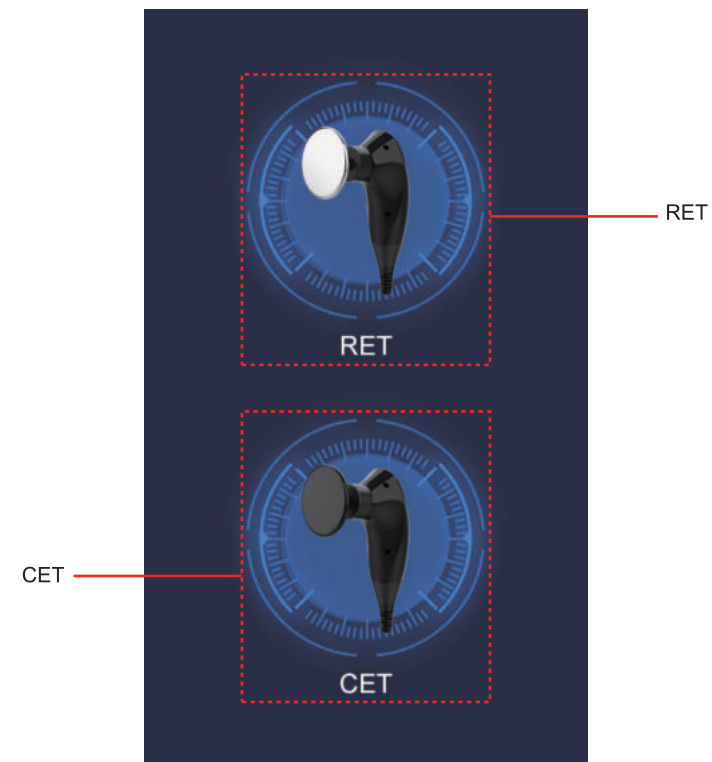

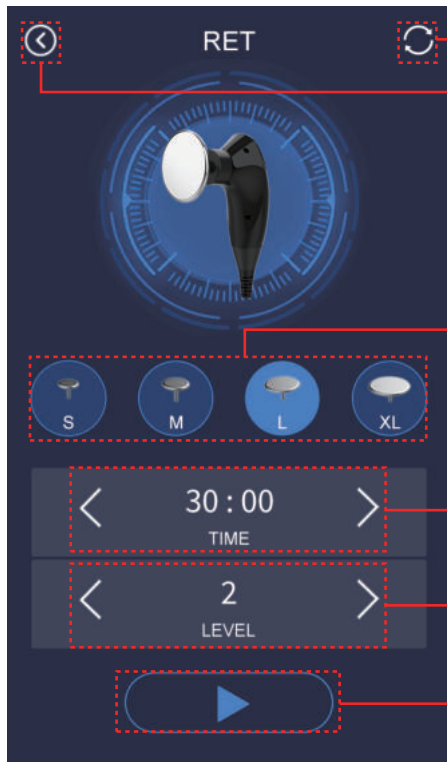

Reset button

Main menu

Probe selection:

S: Suitable for face

M: Suitable for arms

L: Suitable for abdomen and legs

XL: Suitable for back

Time display and set buttons (0 - 60 minutes)

Energy level display and set buttons (0 - 10)

Start / Stop button



Reset button

Main menu

Probe selection:

S: Suitable for eyes

M: Suitable for face

L: Suitable for neck









XL: Suitable for waist, abdomen, legs and back

Time display and set buttons (0 - 60 minutes)

Energy level display and set buttons (0 - 10)

Start / Stop button

## 5. Technical Specification

	Power supply Input: AC110V - 230V 50HZ		Net Weight: 14 KG		
	Power: 185W		Gross Weight: 15.5 KG		
	Dimensions: 52*36*39CM				
	Input Power: 185W				
	Power: 80W		Power: 90W		Power: 80W
	Power: 125W		Power: 100W		Power: 185W
	Power: 185W			Power: 185W	

## 6. Overview

1. Strictly follow the instructions in the manual to use the instrument and train operator.
2. Before using the instrument, use a plug with a grounding pin and ensure the power socket is grounded.
3. Make sure the voltage of the instrument is adapted. If the local power supply voltage is unstable, we recommend adding a power-matched regulated power supply between the mains and the instrument.
4. Remove all the metal objects inside the body to avoid causing accidents or affecting treatment effects.
5. Stop the intake of anti-adiposity drugs 1 - 2 months before the treatment, or extend the treatment course if you want to take the treatment immediately.
6. Do not use the instrument on an empty abdomen, and take the treatment 1 hour later after the meal.
7. Ensure full skin contact with the treatment head throughout the session to avoid uneven heat distribution.

## 7. Maintenance & Cleaning

1. Disconnect the power cord when not in use and store the instrument in a dry, cool, and well-ventilated place.
2. Clean and sanitize the handle with a damp cloth or saline, and then dry it thoroughly with a dry towel to ensure it remains dry.
3. After cleaning the instrument, cover it with a dustcloth or plastic wrap. Before use, ensure to sanitize the handle again for hygienic reasons.
4. Disassembling the instrument and attempting to clean the inside is strictly prohibited. This task should only be performed by professionals.

## 8. FAQ

### 1. How long does it take to see the results of RF treatment?

A: You might experience skin tightness right after the treatment, as the heat stimulation tightens the collagen tissue, and the RF stimulates the subcutaneous tissue bringing the continuous regeneration of collagen, leading to more noticeable results within one week.

### 2. Is RF safe for the skin?

A: RF firming and anti-wrinkle treatment is a non-surgical method that stimulates collagen regeneration and metabolism in the deeper layers of the skin without causing any harm. It's normal to experience temporary heat and redness in the treated area, which indicates increased blood circulation and should subside within a few hours. There's no need to be concerned about this reaction.

### 3. What distinguishes CET from RET?

A: CET, or Capacitive Electric Transfer, involves the application of high-frequency electric waves to the human body through a movable electrode, generating a thermal effect at a depth of 3-5cm under the skin. As the deep tissue reaches temperatures between 45 °C to 60 °C, collagen undergoes immediate contraction, promoting regeneration. This process contributes to the efficacy of skin firming, wrinkle removal, and overall skin rejuvenation. Differing from CET, RET administers electricity directly to the human body through non-insulator electrodes, channeling energy to the deep adipose and fascia layers. This method facilitates the dissolution of adipose tissue without inducing pain. Subsequently, the dissolved adipose tissue is expelled through the body's circulation, achieving the desired outcome of adipose tissue removal.

### 4. What is collagen?

A: Collagen is a biological polymer substance, a white opaque fibrous protein without branched chains, which can replenish essential nutrients needed by all layers of the skin and enhance the collagen activity in the skin, with the effects of locking moisture, moisturizing the skin, delaying aging, improving facial laxity and hair care. Collagen is an essential nutrient for promoting anti-aging effects. As you age, the gradual loss of collagen in your skin becomes evident. Typically, a woman's skin starts showing signs of aging around the age of 20 due to collagen depletion, and the rate of loss peaks at 25. Research suggests that by the age of 40, collagen levels are only about half of what they were at 18. The reduction in collagen and moisture content can contribute to the development of facial folds and wrinkles. This is primarily due to the breakdown of collagen fibers and elastic networks that support the skin. This loss also leads to oxidation, atrophy, and collapse of skin tissue, resulting in various signs of aging such as dehydration, wrinkles, looseness, and lack of elasticity.

## 9. Ask & Answer

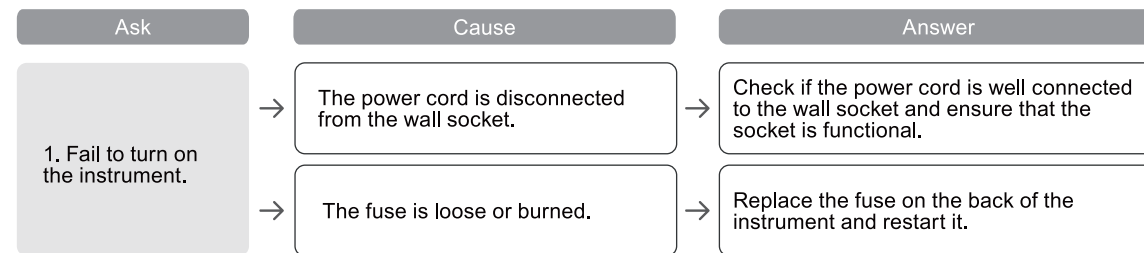

Ask	Cause	Answer
2. The instrument is not working and can't be restarted.	The fuse may have burned out due to unstable voltage or prolonged use.	Please replace the fuse and restart the instrument 5 minutes later.
3.The screen shows an error message.	Data error.	1. Turn off the instrument, disconnect the power cord, and wait for 1 minute to restart the instrument. 2. If the above method doesn't resolve the problem, please contact your dealer.
4.The RF is not functioning.	The handle is not properly connected.	Please confirm if the handle plug is well connected to the main unit.
	Oil in the treatment area could result in insufficient contact between the handle and the body.	Apply some gels to the treatment area after cleaning.
	The handle is not in proper contact with the skin.	Apply some gels to the treatment area after cleaning.

## 10.Operation Guide

Face:



Step 1: RET S/CET M (10 minutes)

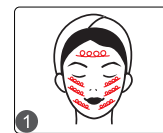

Eye:



Step 1: CET S (10 minutes)

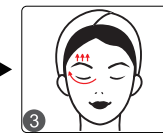
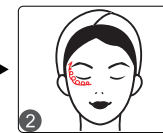

Neck:



Step 1: CET L (15 minutes)

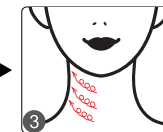
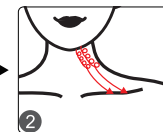
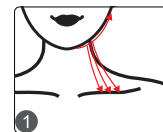

Arm:



Step 1: RET M/CET XL (15minutes)

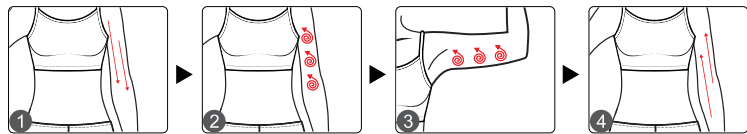

Belly:



Step 1: RET L/CET XL (15 minutes)

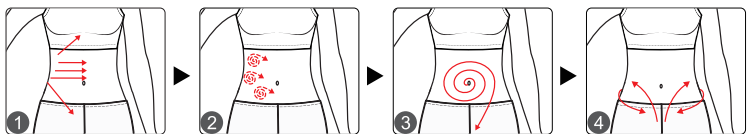

Back:



Step 1: RET XL/CET XL (15 minutes)

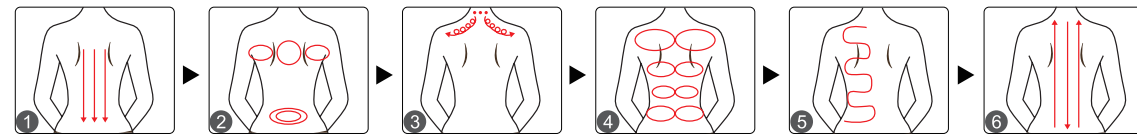

Leg:



Step 1: RET L/CET XL (15 minutes)

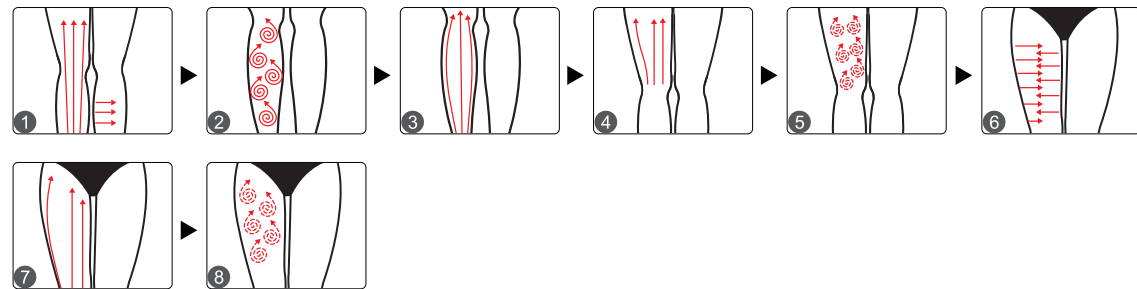

## 11.Warranty & Support

We offer a one-year warranty on the main unit and a three-month warranty on components.

Product Name: Radio Frequency Analyzer

Product Model: BS-32K1

Production Date: \_\_\_\_\_

Quality Inspection: \_\_\_\_\_

